

# QUICK REFERENCE GUIDE



## Foreword

We are pleased to welcome you to the family of Perodua owners. As you know, the performance and durability of a vehicle depends, to a large extent, upon the way it is maintained and driven.

This Quick Reference Guide is a summary of basic vehicle operations. It contains brief description of fundamental operations so you can locate and use the vehicle's main equipment quickly and easily.

The Quick Reference Guide is not intended as a substitute for the vehicle Owner's Manual.

Full Owner's Manual can be downloaded from Perodua Official Website ([www.perodua.com.my](http://www.perodua.com.my)) or Perodua e-Owner's Manual page (<https://eownersmanual.perodua.com.my>).

For full awareness of your rights under the warranty granted and limitation set, please refer to the Warranty Booklet in Perodua e-Owners Manual page.

We strongly encourage you to review the Owner's Manual and any other supplementary manuals so you will have better understanding of your vehicle's capabilities and limitations.

If you have any questions, feel free to contact your authorised Perodua Service Centre. We are ready to provide qualified service and assistance

### **PERODUA SALES SDN. BHD.**

©2021 PERODUA SALES SDN. BHD.

All rights reserved. This material may not be produced or copied, in whole or in part, without the written permission of Perodua Sales Sdn. Bhd.

Scan the QR code to visit the  
e-Owner's Manual Website

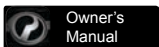
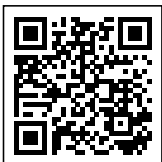

## **DISCLAIMER**

The information in this manual is subject to change without notice. No part of this manual may be reproduced or transmitted in any form or by any means electronic or mechanical including photocopying, recording or information storage and retrieval systems for any purpose other than personal use without our written permission.

While every effort has been made to ensure that the information and contents in the manual are complete, accurate, up-to-date, reliable and non-misleading, we cannot be held responsible for mistakes, inaccuracies, or errors found in the manual. Nor is any liability assumed for damages resulting from the reliance and use of information contained herein. This manual is provided without any representation or warranties, express or implied.

**PERODUA SALES SDN. BHD.**

# INDEX

## OVERVIEW

INSTRUMENT PANEL	1
INSTRUMENT CLUSTER	2
INDICATOR SYMBOL	2
INTERIOR VIEW	4
SMART ENTRY	5
PUSH START/STOP BUTTON	8
HOOD & FUEL TANK DOOR RELEASE	10
ENGINE COMPARTMENT	11

## FEATURES & OPERATIONS

CLOCK	12
SEATS	12
TILT STEERING	15
SIDE MIRROR REMOTE CONTROL	16
POWER WINDOW	16
LIGHTS, TURN SIGNALS & WIPER	17
ADVANCED SAFETY ASSIST (A.S.A.) 2.0*	19
PRE-COLLISION WARNING	20
PRE-COLLISION BRAKING	20
PEDAL MISOPERATION CONTROL	21
FRONT DEPARTURE ALERT	21
'ECO IDLE' SYSTEM	22
HILL - START ASSIST (HSA)	24
FRONT CORNER SENSOR SWITCH	25
REVERSE CAMERA	25
VSC & TRC SYSTEMS	26
EMERGENCY STOP SIGNAL (ESS)	27

## FEATURES & OPERATIONS

### (continued)

AIR CONTROL SYSTEMS	28
REAR COOLER SYSTEM	28
CHANGING BACKGROUND COLOUR	29
AUDIO	30
PAIRING A BLUETOOTH DEVICE	31
STEERING SWITCH	31
USB POWER OUTLET	31
HDMI POWER OUTLET*	31
POWER SOCKET	32
GLASSES CASE	32
BUILT-IN TOLL READER	32
ROOF RAIL*	32
DVR*	33
SEAT POCKET	33

## SAFETY & EMERGENCY

FLOOR MAT INSTALLATION	34
SEAT BELTS	34
FRONT SEAT BELT PRETENSIONER	35
AIR BAGS	35
CHILD RESTRAINT SYSTEM	36
DOOR LOCK	36
DOOR CHILD SAFETY LOCK	36
WINDOW JAM PROTECTION	37
TOOL BOX	37
SPARE TYRE LOCATION	37

\* : The equipment may vary according to the vehicle grade and options.

# OVERVIEW

## INSTRUMENT PANEL

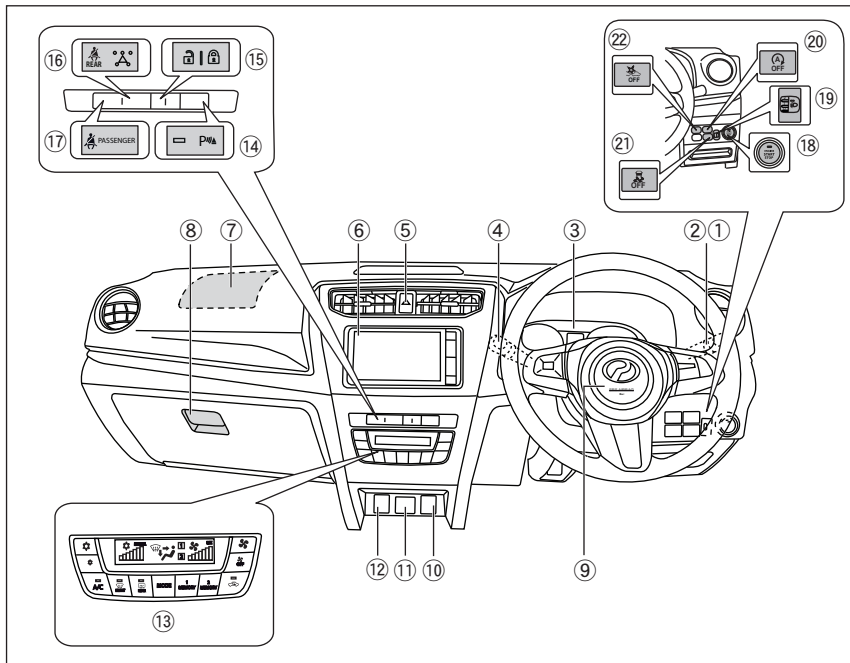

- |                                    |  |
|------------------------------------|--|
| ① Turn signal control lever        | ⑫ Power socket                               |
| ② Headlight control                | ⑬ Air conditioner control panel              |
| ③ Combination meter panel          | ⑭ Front corner sensor switch                 |
| ④ Wiper and washer control lever   | ⑮ Central doors lock switch                  |
| ⑤ Hazard warning signal switch     | ⑯ Rear passenger seat belt indicator         |
| ⑥ Audio control panel              | ⑰ Front passenger seat belt indicator        |
| ⑦ SRS air bags for front passenger | ⑱ Engine start/stop button                   |
| ⑧ Glove box                        | ⑲ Headlight levelling switch                 |
| ⑨ SRS air bags for driver          | ⑳ Eco Idle OFF switch                        |
| ⑩ HDMI power outlet*               | ㉑ VSC & TRC OFF switch                       |
| ⑪ USB power outlet                 | ㉒ Advanced Safety Assist (A.S.A.) OFF switch |

\* : The equipment may vary according to the vehicle grade and options.

## INSTRUMENT CLUSTER

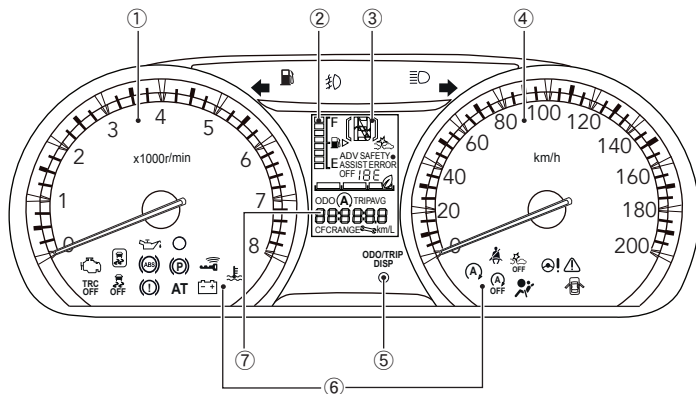

- ① Tachometer
- ② Fuel Gauge
- ③ AT Shift Indicator Light
- ④ Speedometer
- ⑤ Odometer Display Reset Button
- ⑥ Indicator & Warning Light
- ⑦ Multi-information Display

If indicator & Warning lights do not turn off within a few seconds of starting the engine, there may be a malfunction. Have your car checked at an authorised Perodua Service Centre.

## INDICATOR SYMBOL

For details, refer to "Indicator & Warning Lights" in Section 5 Owner's Manual.



Parking brake warning light



Door ajar warning light



Brake warning light



Low fuel level warning light



Oil pressure warning light



Water temperature warning light



Battery charge warning light



Malfunction indicator light (MIL)



Air bag warning light



ABS (Anti-lock Braking System) warning light



Security indicator light



Power steering warning light

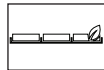

Eco bar indicator light



Key-free warning light



Service information reminder indicator



Seat belt warning light (Rear passenger)



VSC OFF indicator light



A.S.A. OFF indicator light \*



TRC OFF indicator light



A.S.A. operation indicator \*



Slip indicator light



Seat belt warning light (Driver)



Eco Idle ready indicator light



AT warning light

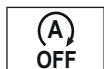

Eco Idle OFF indicator light

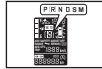

Automatic transmission shift indicator light



Multi information display



High beam indicator light



Speedometer

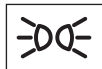

Tail light- on indicator light



Master warning light\*



Tachometer



Front fog light-on indicator light\*



Advance Safety Assist (A.S.A.) error warning light\*

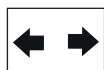

Turn signal / Hazard warning signal indicator light



Advance Safety Assist (A.S.A.) OFF warning light\*

If indicator does not turn off within a few seconds of starting engine, there may be a malfunction. Have the system checked by an authorised Perodua Service Centre.

\* : The equipment may vary according to the vehicle grade and options.

## INTERIOR VIEW

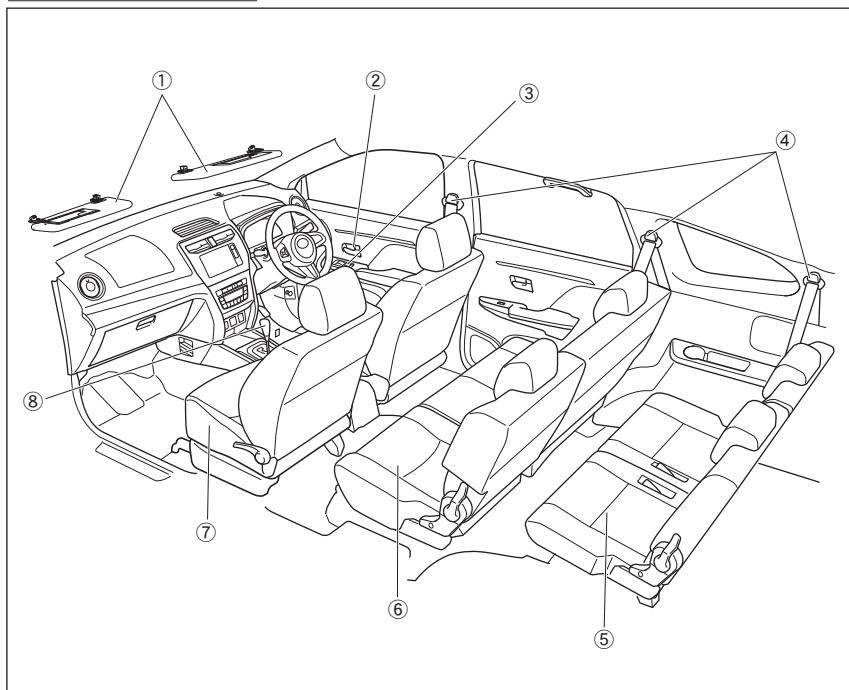

- ① Sun Visor
- ② Door lock / unlock switch
- ③ Power window switch
- ④ Seat belt

- ⑤ Third row seat
- ⑥ Second row seat
- ⑦ Front seat
- ⑧ Shift lever



## SMART ENTRY

### LOCKING OPERATION

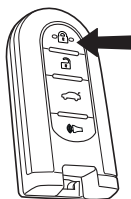

 : Press once to lock

### UNLOCKING OPERATION

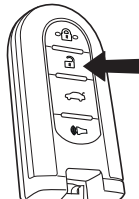

 Press once :  
Unlock driver door  
Press twice :  
Unlock all doors

### BOOT UNLOCKING OPERATION

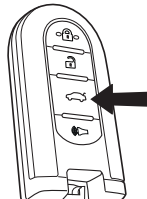

 Press once to unlock

### PANIC ALARM BUTTON

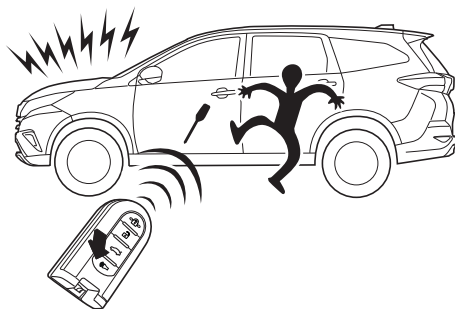

Press and hold

To stop alarm, press button ,  or .

The alarm will sound for 45 seconds if any of these buttons are not pressed.

### EMERGENCY KEY

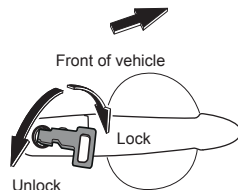
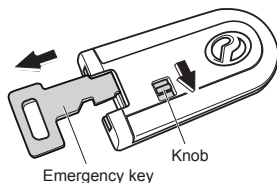

Push the knob downwards to release the emergency key.

Use the emergency key if the Smart Key battery is weak or if the Smart Entry function does not operate properly.

## LOCK / UNLOCK DOORS

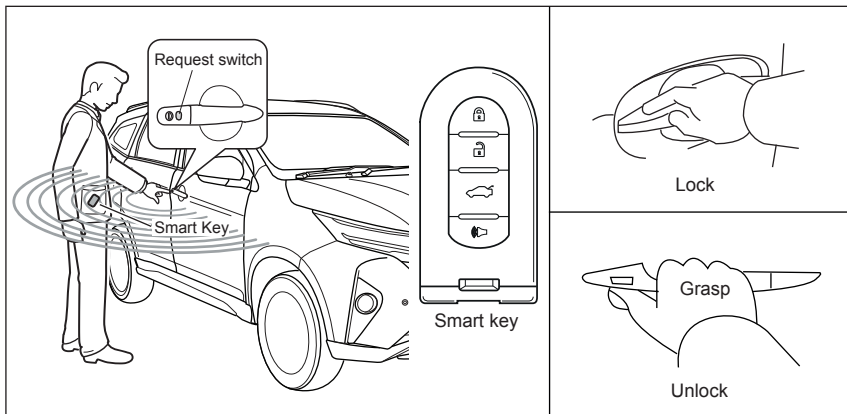

## UNLOCK BACK DOOR

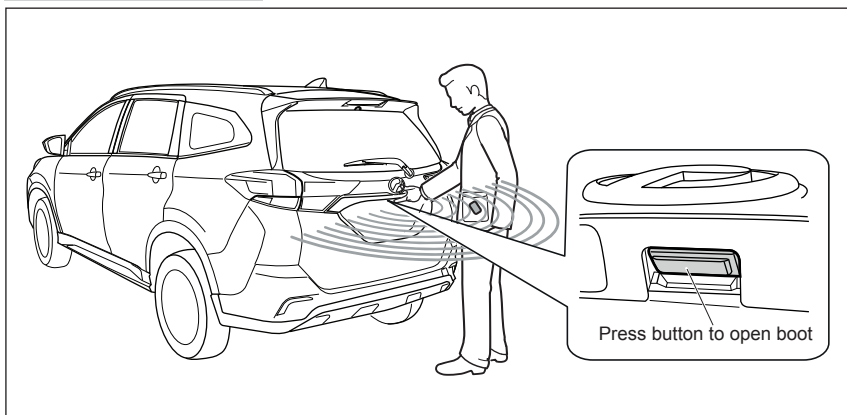

Operating range may vary by surrounding conditions.

- (i) Key-free: Within 3 metres from centre of vehicle.
- (ii) Request switch: When the smart key is within approximately 80cm from outer door handle.

## AUTOMATIC DOOR LOCKING AND UNLOCKING SYSTEMS

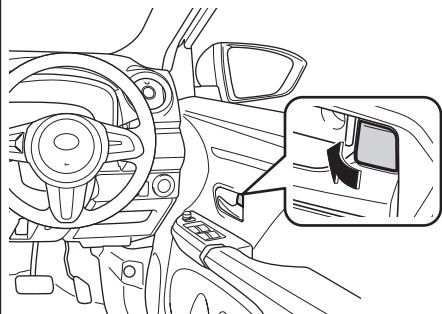

All doors are locked when :

- The vehicle speed is more than 20 km/h.

All the doors will be unlocked when :

- The vehicle is under strong impact from the front, back, left and right.
- This system will activate depending on the strength of the impact and the form of the accident.

## PUSH START/STOP BUTTON

### PUSH START SYSTEM

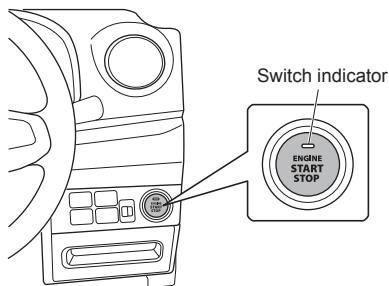

The Push Start/Stop Button allows you to start and stop the engine without inserting a key into ignition.

### TO START ENGINE

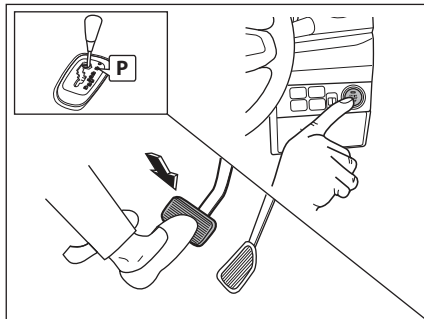

### TO STOP ENGINE

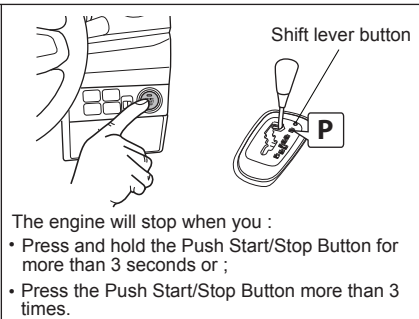

### TO CHANGE ENGINE IGNITION MODE

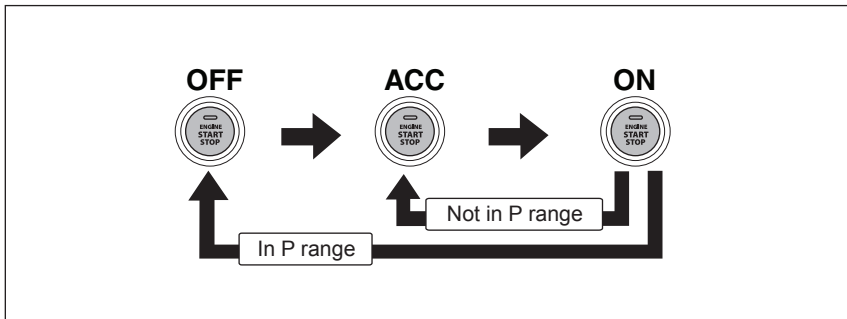

When brake pedal is not depressed, pressing the Push Start/Stop Button will change the engine mode.

## SWITCHING ENGINE ON WHEN SMART KEY BATTERY IS WEAK

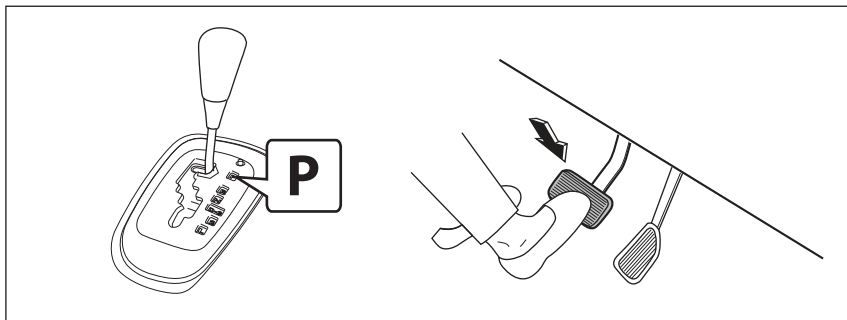

- 1 Move the gear shift to 'P' while depressing the brake pedal.

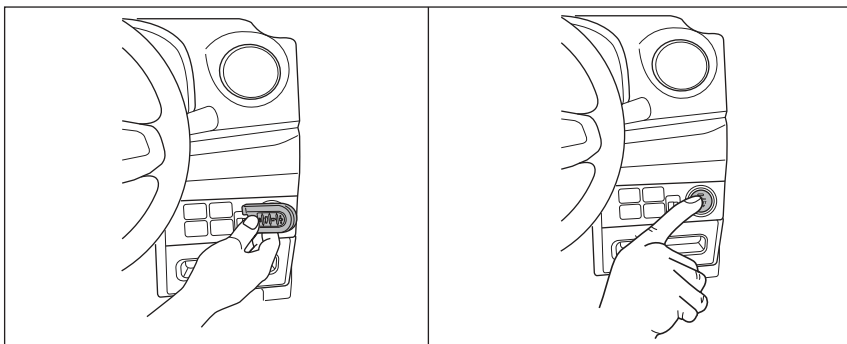

- 2 Touch the Push Start/Stop Button with Smart Key until the buzzer sounds and the engine switch indicator turn green.
- 3 Push the Push Start/Stop Button within 4 seconds after the buzzer sounds and the engine switch indicator turns green.

## HOOD & FUEL TANK DOOR RELEASE

### HOOD RELEASE

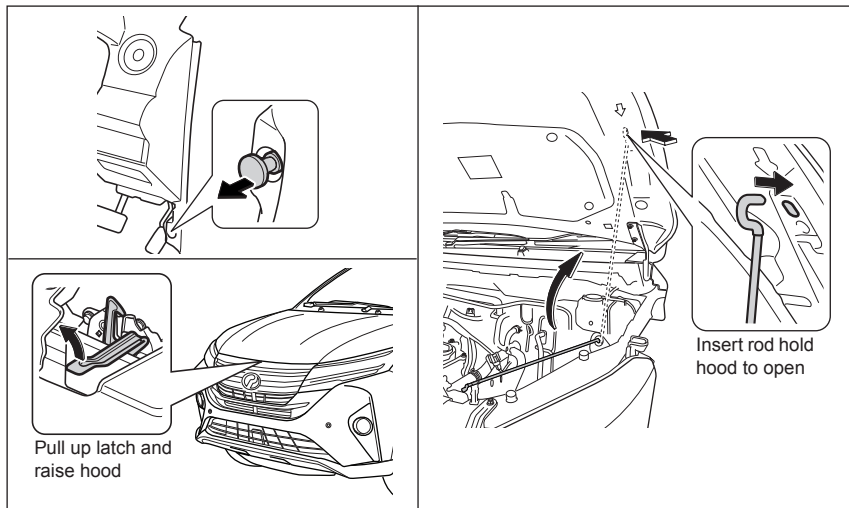

### FUEL TANK DOOR RELEASE AND CAP OPENING

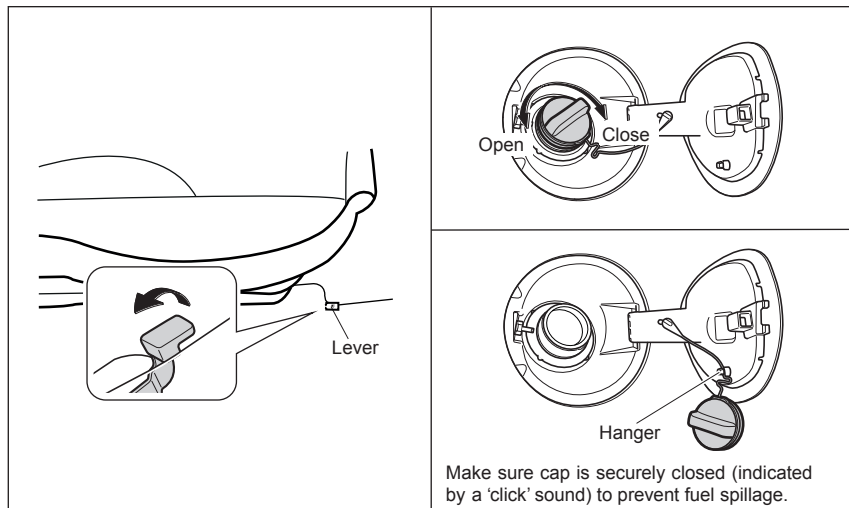

## ENGINE COMPARTMENT

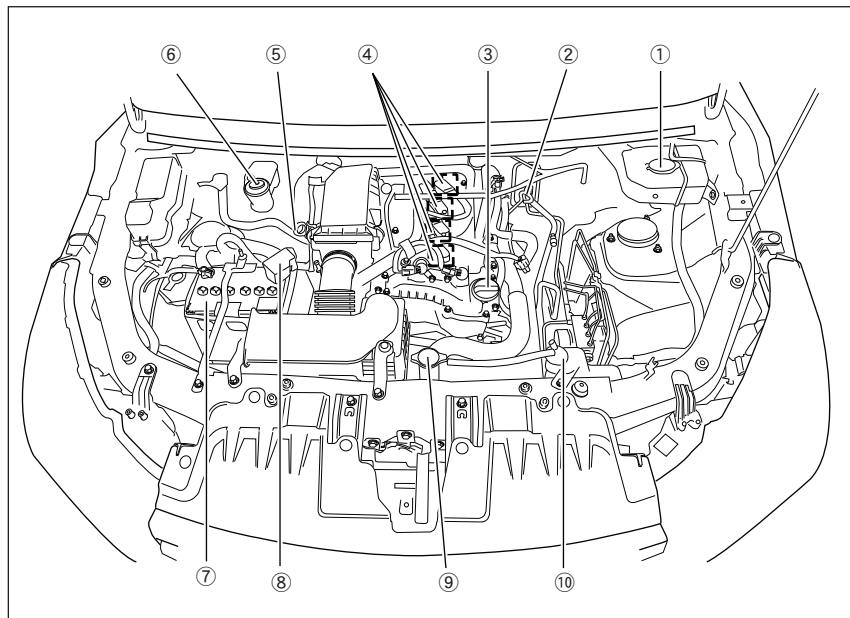

- |  |                               |
|--|-------------------------------|
| ① Windshield washer fluid tanks          | ⑥ Brake fluid reserve tank    |
| ② Automatic transmission oil level gauge | ⑦ Battery                     |
| ③ Engine oil filter cap                  | ⑧ Fusible link                |
| ④ Spark plug                             | ⑨ Radiator cap                |
| ⑤ Engine oil level gauge                 | ⑩ Engine coolant reserve tank |

Regularly scheduled maintenance, including oil changes, will help extend the life of your vehicle and maintain performance. Please refer to the maintenance schedule in section 13 of the Owner's Manual.

# FEATURES & OPERATIONS

## CLOCK



- ① Press [setting] button on main menu screen.
- ② Press [time] to display the setting.
- ③ Adjust date and clock time by scrolling up or down on required column.

## SEATS

### SEAT ADJUSTMENT

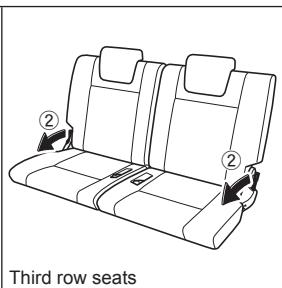
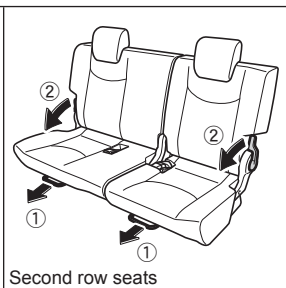
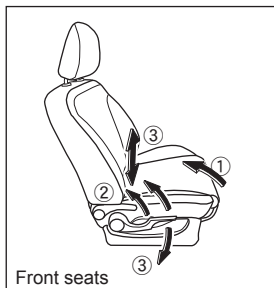

- ① Seat position (forward/backward)
- ② Seat back angle
- ③ Seat hight adjuster (driver's side only)



## FOLDING SECOND SEAT

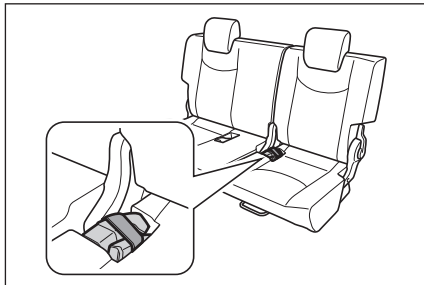

① Stow the seat belt buckles

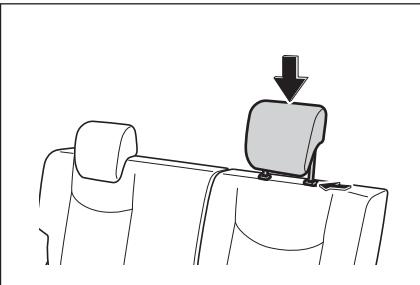

② Lower the head restraint

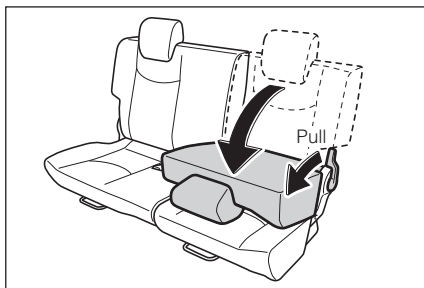

③ Fold the seatback down

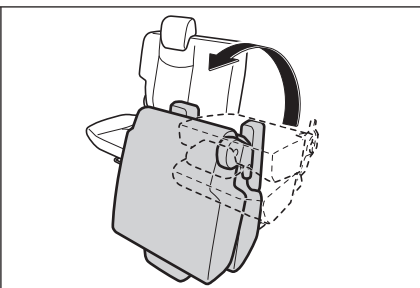

④ Swing the whole seat up and forward

## FOLDING THIRD SEAT

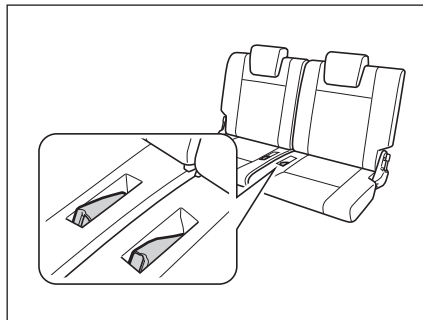

① Stow the seat belt buckles

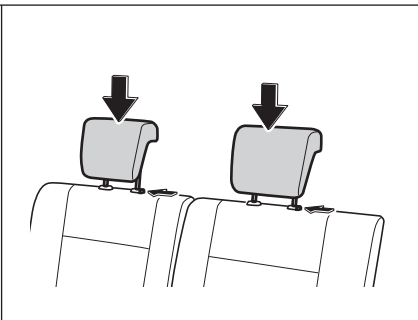

② Lower the head restraint

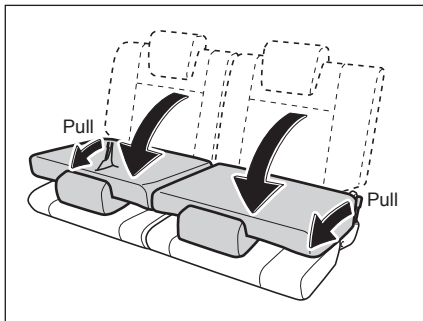

③ Fold the seatback down

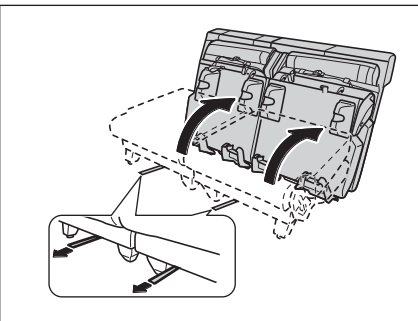

④ Swing the whole seat up and forward

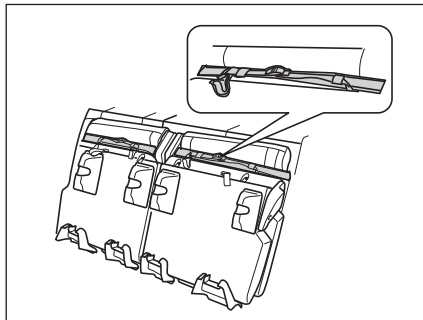

⑤ Take out the hook from the strap

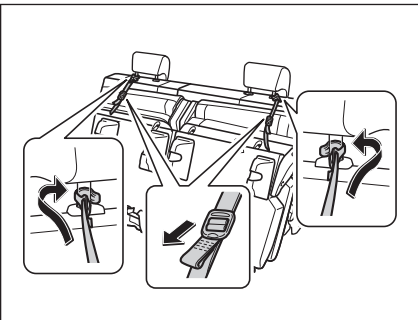

⑥ Hook the holding strap to the head restraint

## HEAD RESTRAINTS

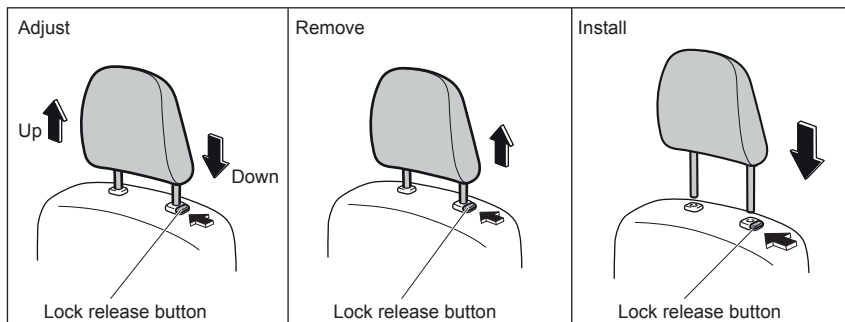

## TILT STEERING

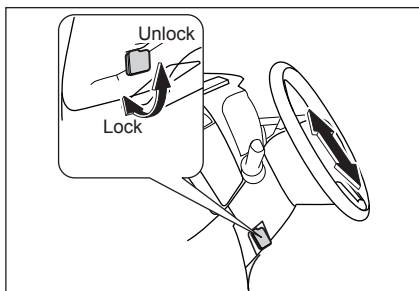

## SIDE MIRROR REMOTE CONTROL

### TO ADJUST

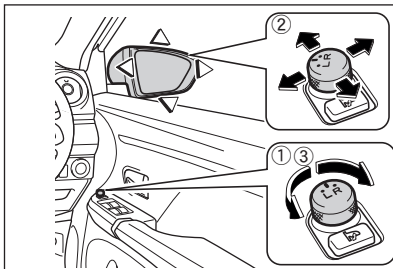

### TO FOLD

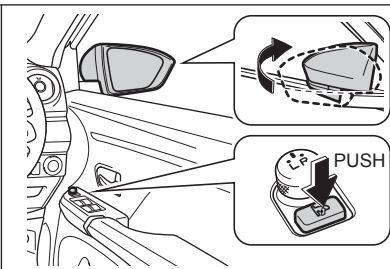

\*Ignition switch set to "ACC" or "ON" position for use.

- ① Set the switch to left or right.
- ② Push the switch to adjust the mirror.
- ③ Return the switch to neutral (OFF) position.

## POWER WINDOW

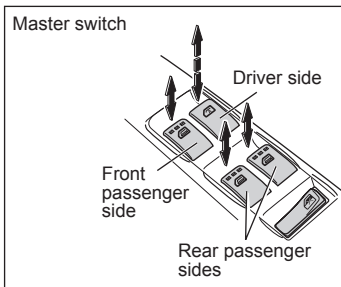

### Passenger

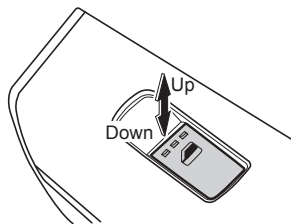

### Automatic operation

Push the switch down or pull it completely up and release to fully open or close. To stop window partially, push the switch lightly in the opposite direction during opening or closing.

## LIGHTS, TURN SIGNALS & WIPER

### TURN SIGNAL CONTROL LEVER

- ① Left turn.
- ② Lane change (left).
- ③ Lane change (right).
- ④ Right turn.

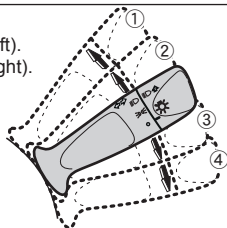

### HIGH BEAM & HEADLIGHT FLASH

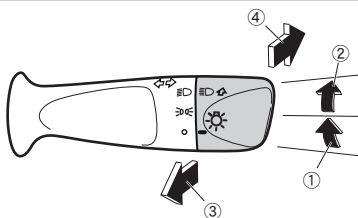

### FOLLOW ME HOME FUNCTION

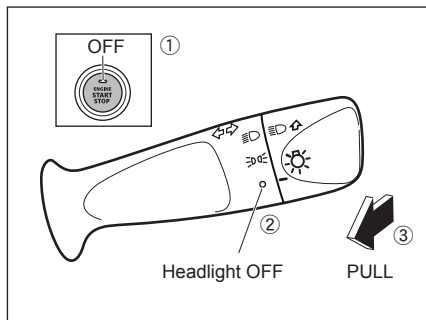

Headlight will turn "ON" for 30 seconds before it will automatically turn "OFF".

### FOG LIGHT SWITCH\*

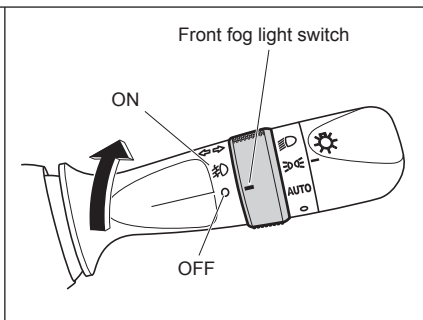

### HEADLIGHT LEVELLING SWITCH

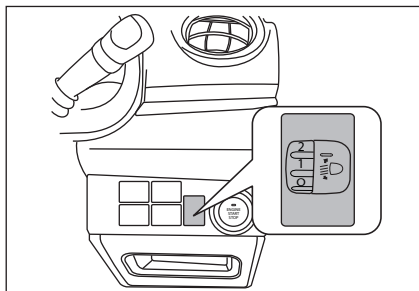

\* : The equipment may vary according to the vehicle grade and options.

## AUTO LIGHT FUNCTION\*

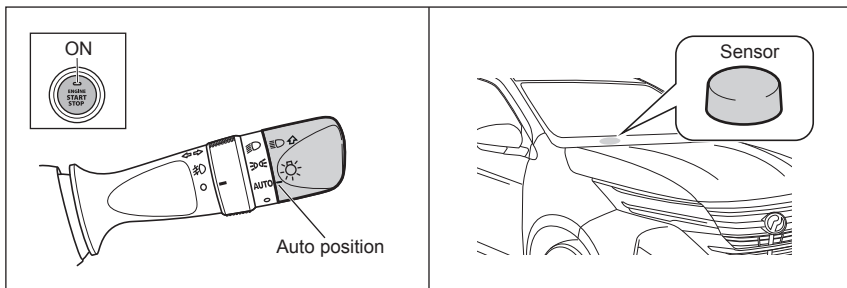

- The headlight turn on when the auto light sensor sense dark condition.
- Do not shield the sensor as the function may not operate properly.

## AUTO LIGHT OFF FUNCTION

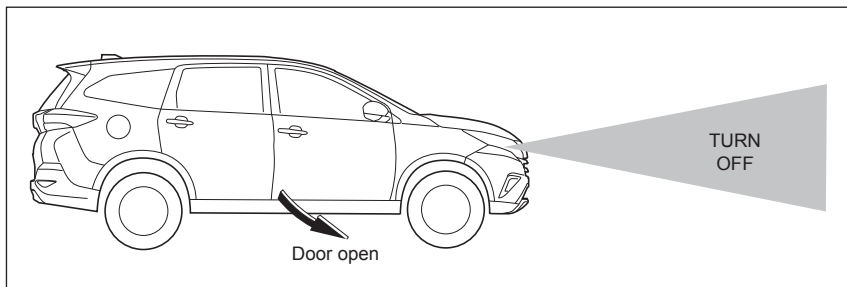

The headlights are automatically turned off if the driver's door opened after the engine switch is turned to "OFF" or "ACC" or after 10 minutes when the engine switch is in "OFF" position and the driver's door is remain closed.

## WINDSHIELD WIPER AND WASHER LEVER

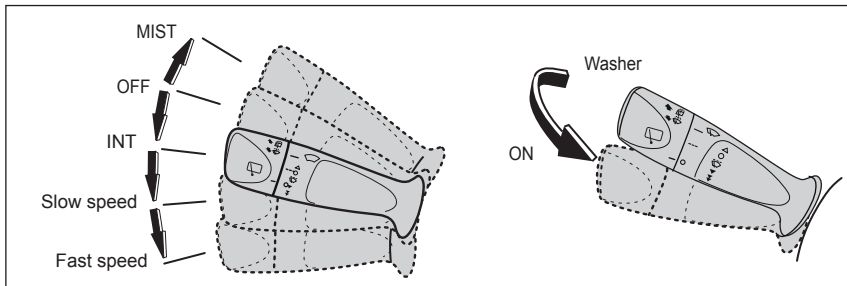

During intermittent (INT) operation, the interval becomes shorter as the driving speed rises.

\* : The equipment may vary according to the vehicle grade and options.

## ADVANCED SAFETY ASSIST (A.S.A.) 2.0\*

A.S.A. is a system designed to support the driver's awareness, decision making and vehicle operation contributing to a safe driving experience.

### STEREO CAMERA

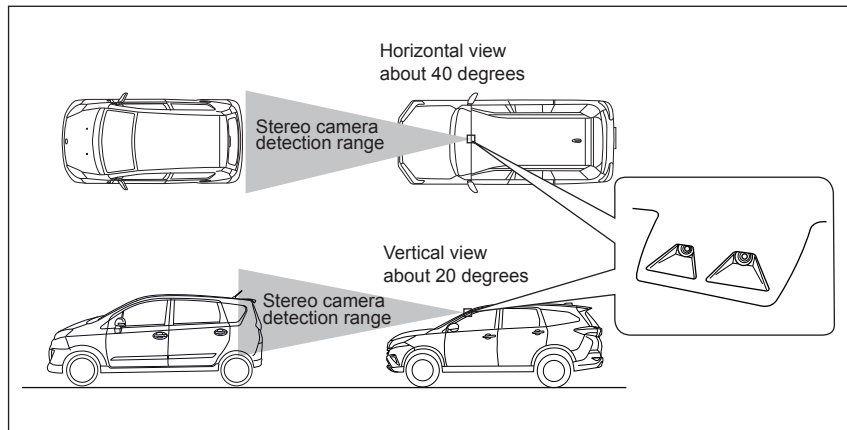

- A stereo camera mounted in front of the inside rear view mirror which detect vehicle up to about 60m (pedestrian up to 30m) in front.
- The stereo camera will not operate properly if the wind shield view in front of the camera is obstructed by something, dirt, foggy, sticker etc.

### A.S.A. OFF SWITCH

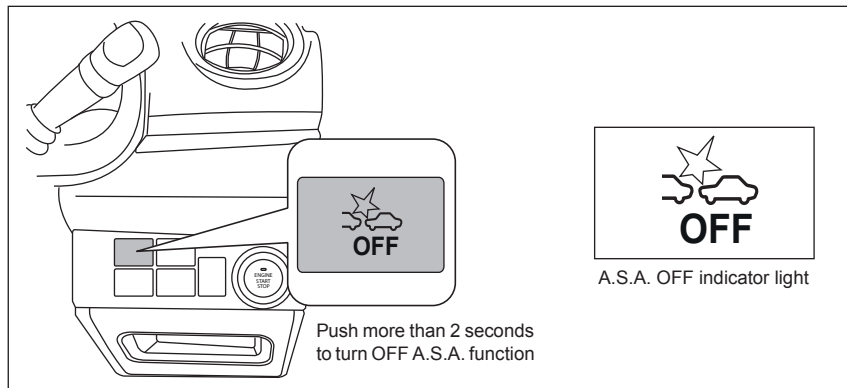

A.S.A. OFF indicator light will illuminate at the meter panel. Every time you start the engine by the engine switch operation, A.S.A. function will return to ready state.

\* : The equipment may vary according to the vehicle grade and options.

## PRE-COLLISION WARNING

Alert the driver when it detects a risk of frontal collision.

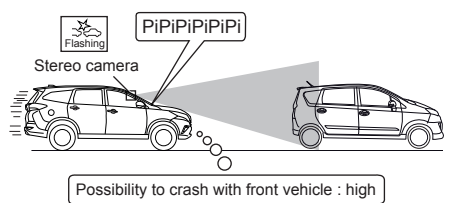

The diagram illustrates the Pre-Collision Warning system. A car on the left is equipped with a 'Stereo camera' (indicated by a line pointing to the front of the car) and a 'Flashing' icon (a lightning bolt). A speech bubble from the car contains the sound 'PiPiPiPiPiPi'. A shaded area represents the camera's field of view, which includes a car on the right. Below the cars, a box states 'Possibility to crash with front vehicle : high'.

- The system alerts the driver when there is a risk of collision with a front obstacle through recognition from the stereo camera.
- This function operates when own vehicle speed and the speed difference between the front obstacles are **about 4 ~ 100 km/h (vehicle)** or **about 4 ~ 50 km/h (pedestrian)**

## PRE-COLLISION BRAKING

Apply brakes to avoid the collision or mitigate damage.

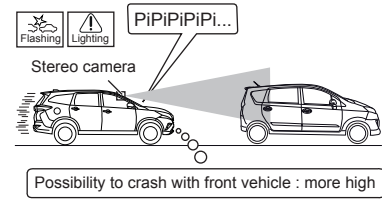

The diagram illustrates the Pre-Collision Braking system. A car on the left is equipped with a 'Stereo camera' (indicated by a line pointing to the front of the car) and icons for 'Flashing' (a lightning bolt) and 'Lighting' (a triangle with an exclamation mark). A speech bubble from the car contains the sound 'PiPiPiPiPi...'. A shaded area represents the camera's field of view, which includes a car on the right. Below the cars, a box states 'Possibility to crash with front vehicle : more high'.

- The system implements emergency braking when it detects an increasing risk of collision with the speed between own vehicle and front obstacles are **about 4~80 km/h (vehicle)** or **about 4~50 km/h (pedestrian)**.
- Collision can be avoided if the speed between own vehicle and front obstacles are about below 30km/h.
- When the driver step on the brake pedal, this function apply additional braking force in reducing the damage with the speed between own vehicle and front obstacles are **about 30~80 km/h (vehicle)** or **about 30~50 km/h (pedestrian)**.

- Driver should instantly press the brake pedal to continue stop condition because the vehicle will slowly starts moving after about 1.5 seconds.
- Pre-collision braking will be disabled after the secondary brake has been activated 3 times. It will reset when engine restarts.



## PEDAL MISOPERATION CONTROL

Suppresses engine output when the driver accidentally stomps the accelerator pedal.

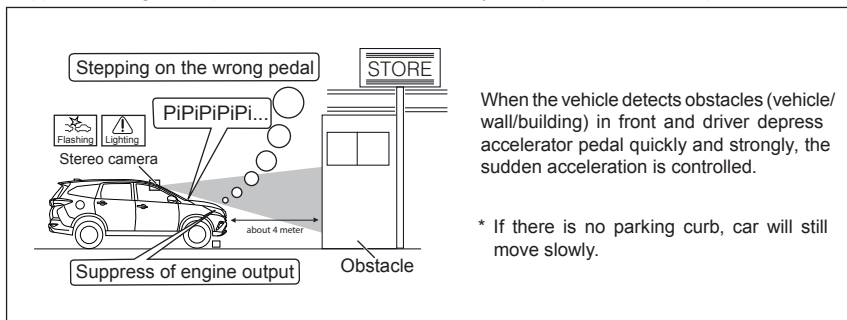

If the depression of accelerator pedal is strong but quick at under 4 km/h, only warning is operated.

## FRONT DEPARTURE ALERT

Alerts the driver when the vehicle in front has moved.

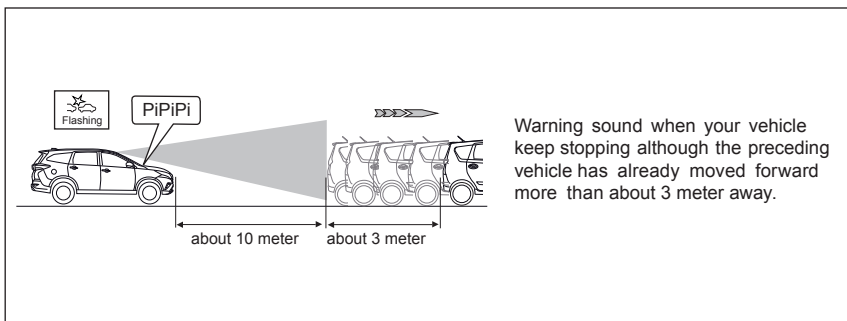

Shift position is other than **P** & **R** and distance between the stopped preceding vehicle and own vehicles is within about 10 meter.

## 'ECO IDLE' SYSTEM



The 'Eco Idle' system automatically shuts down the engine when the vehicle is idle and restarts it when the vehicle returns to motion, improving fuel consumption, reducing emissions and minimising idling noise.

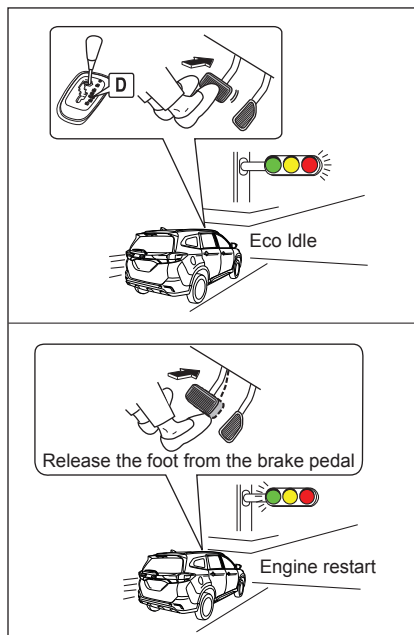
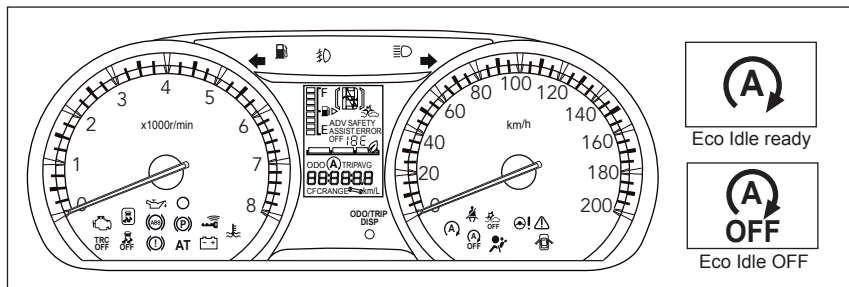

- ① When conditions for 'Eco Idle' mode are fulfilled during driving, the 'Eco Idle' ready indicator turns on in green (standby state).
- ② While the gear shift is in **D**, depress the brake pedal and stop your vehicle for 'Eco Idle' mode. The indicator will remain on in green during 'Eco Idle' mode.
- ③ The engine restarts when foot is released from the brake pedal. The 'Eco Idle' ready indicator will turn off.
- ④ The 'Eco Idle' ready indicator turn on in green again after conditions for 'Eco Idle' mode are fulfilled.

'Eco Idle' may not operate normally under the following conditions. Have the vehicle checked by an authorized Perodua Service Centre

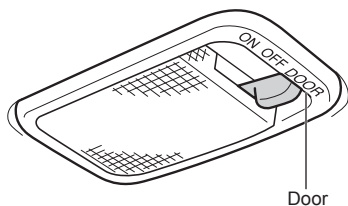

The interior light turns on when the driver's door is closed and does not turn on when the driver's door is opened.



Door ajar warning light turns on when the driver's door is closed and does not turn on when the driver's door is opened.



Seat belt reminder light flashes when driver's seatbelt is fastened, and/or does not flash when driver's seat belt is not fastened.

## HILL - START ASSIST (HSA)

Hill-start Assist (HSA) helps to prevent the vehicle from rolling back when starting up again from a stopped position on an incline.

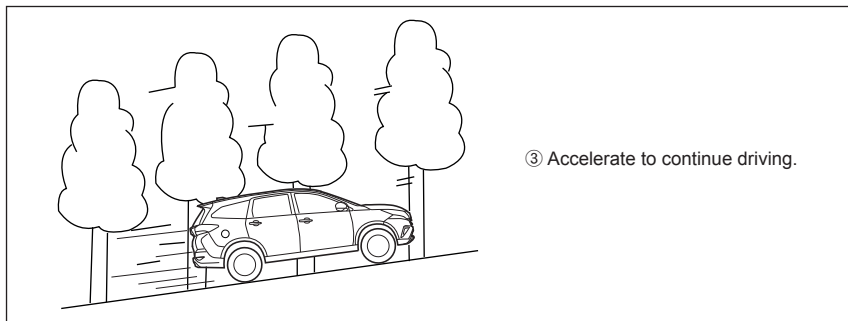
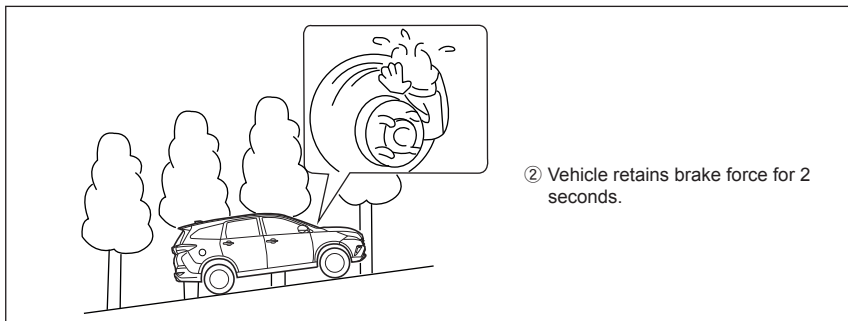
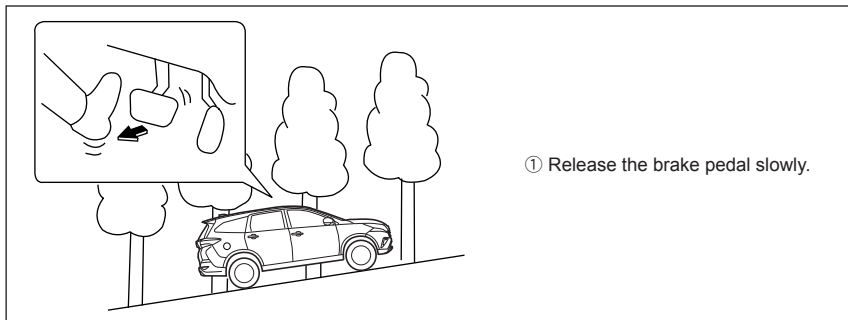

## FRONT CORNER SENSOR SWITCH

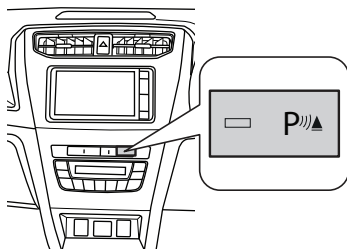

- This function will assist driver to park the vehicle during front parking
- Press the switch to activate the system

## REVERSE CAMERA

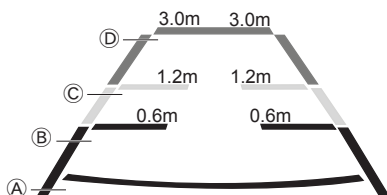
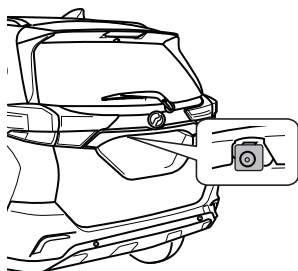

- |                     |            |
|---------------------|------------|
| (A) Bumper red line | (C) Yellow |
| (B) Red             | (D) Green  |

## VSC & TRC SYSTEMS

### Vehicle Stability Control (VSC)

Keeps the vehicle stable during sudden turns or on slippery roads.

### Traction Control (TRC)

Assists with keeping the stability of the vehicle when accelerating on slippery roads.

### VSC & TRC OPERATION

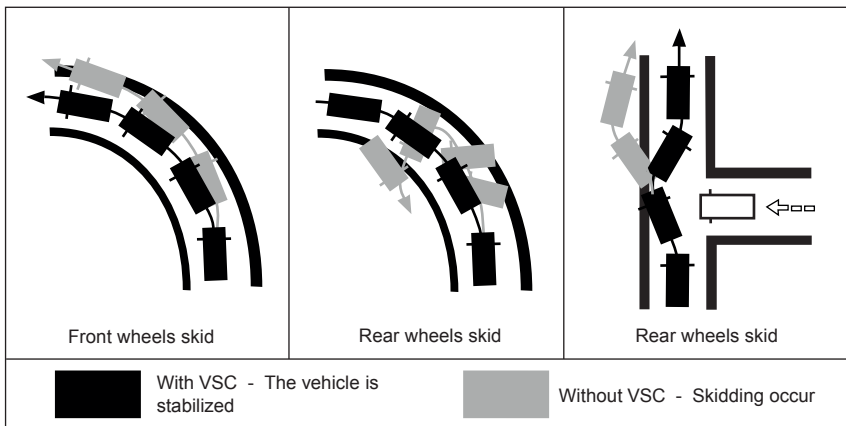

- These situations may arise depending on road, tyre and weather conditions.
- The vehicle is more secure if it is equipped with ABS (Anti-lock Braking System) & EBD (Electronic Brake force Distribution.)

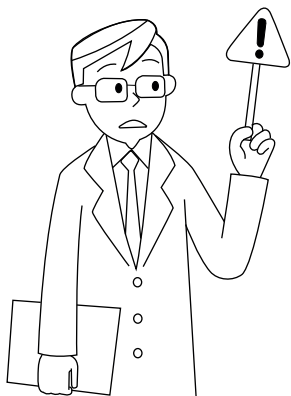

### IMPORTANT:

Even when VSC & TRC are operation, there are limits to the systems' traction and stability control. Dangerous driving may still cause accidents.

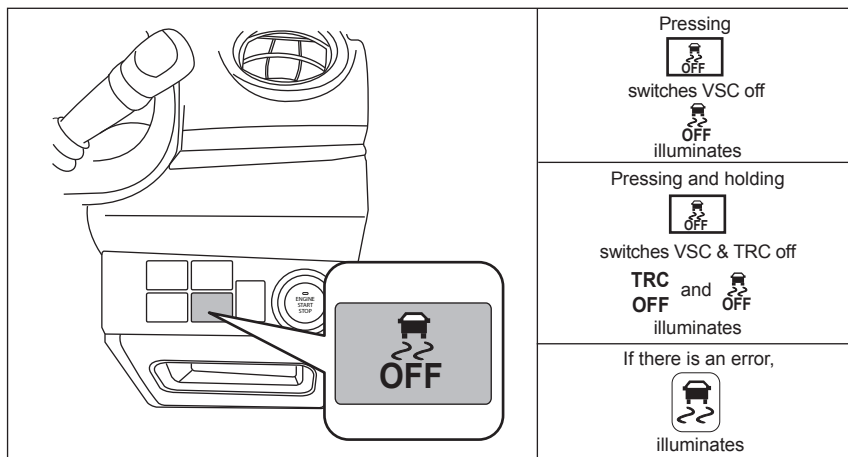

## EMERGENCY STOP SIGNAL (ESS)

Emergency stop signal (ESS) is a function to reduce the rear - end collision by lashing the hazard warning signal light turn on when sudden braking applied, to warn the vehicle that follows.

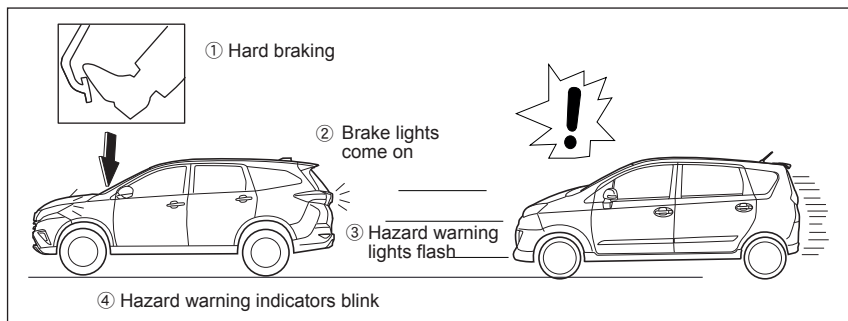

ESS operates under this condition :

- Hazard warning signal light is OFF.
- Vehicle speed is about more than 60 km/h.
- The system detect any "hard" or "sudden braking" or ABS is activated.

Driver is obliged for a safe driving and avoid unnecessary sudden braking.

## AIR CONTROL SYSTEMS

### TURN ON THE AIR CONDITIONER

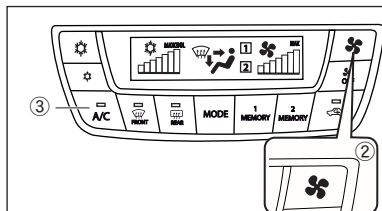

- ① Ignition switch on.
- ② Press
- ③ Press A/C.

### TEMPERATURE CONTROL

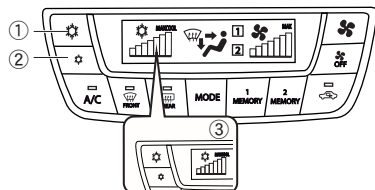

- ① Press to increase level.
- ② Press to decrease level.
- ③ MAXCOOL will appear after pressing to the maximum/end.

### BLOWER FAN SWITCH

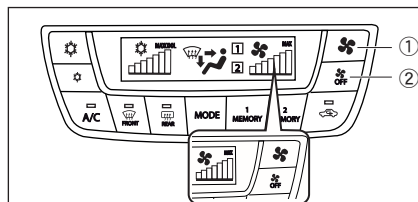

- ① Press to increase level.
- ② Press to decrease level.
- ③ Press until no level display of LCD to turn off the blower.

### SET MEMORY

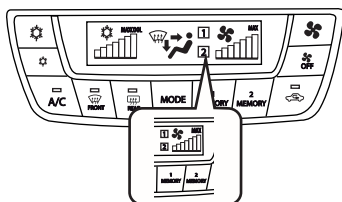

- ① Set preferred setting of air conditioner by pressing **MEMORY 1** or **MEMORY 2** button.
- ② To replace a memory, hold either button for 1.5 second.

## REAR COOLER SYSTEM

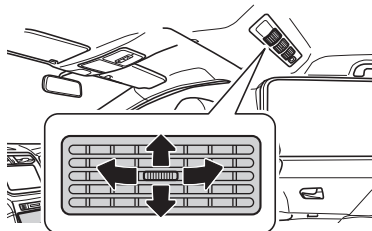
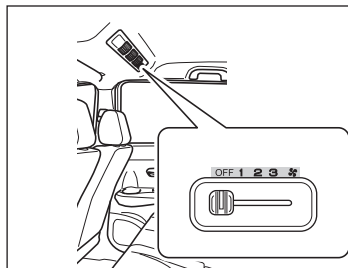



## CHANGING BACKGROUND COLOUR

- ① Touch [Setting] button on Main Menu Screen to set various setting functions.

(Type A)



(Type B)

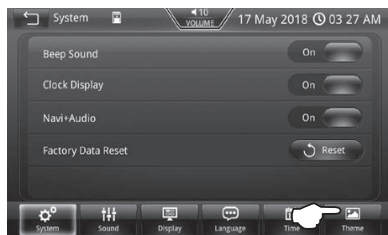

- ② Background – Select and touch desired colour. The selected background colour will also be applied to the navigation user interface.



## AUDIO

(Type A)

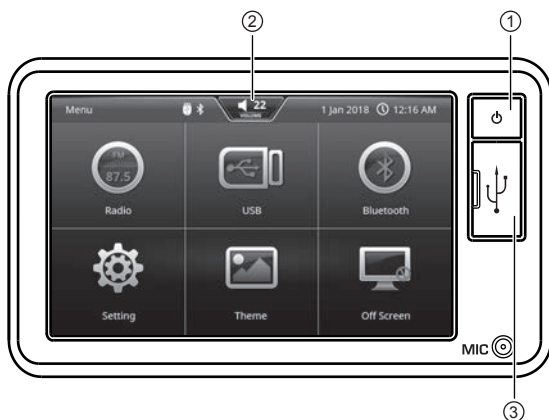

(Type B)

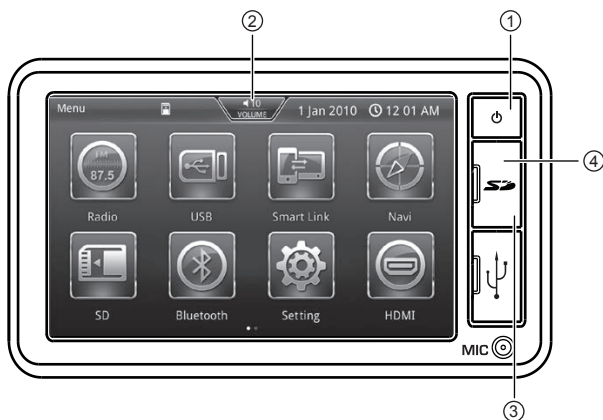

- ① Power button
- ② Volume button

- ③ USB door
- ④ SD card

## PAIRING A BLUETOOTH DEVICE

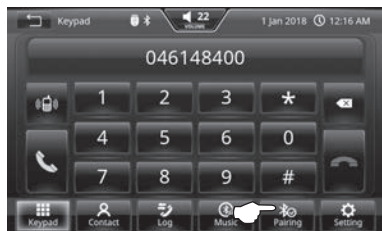

**\*\* Do not attempt bluetooth pairing driving \*\***

- 1) Press [Bluetooth] button on main menu screen.
- 2) Press [pairing].
- 3) Search new device in bluetooth mode using your phone until you found "PERODUA".
- 4) Audio System default name is "PERODUA" and passkey is 6-digit similar on both mobile phone and audio system.
- 5) LCD will display "CONNECTED" and " \*".
- 6) New bluetooth system enters into standby mode and ready to use.

\*A maximum of 8 devices can be paired to the system.

## STEERING SWITCH

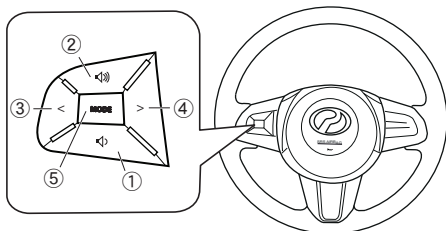

- ① Volume down button
- ② Volume up button
- ③ Tune down button
- ④ Tune up button
- ⑤ Mode button

## USB POWER OUTLET

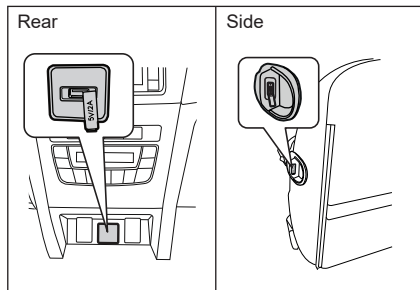

## HDMI POWER OUTLET\*

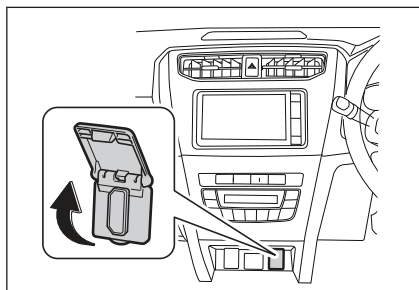

\* : The equipment may vary according to the vehicle grade and options.

## POWER SOCKET

### FRONT

### REAR

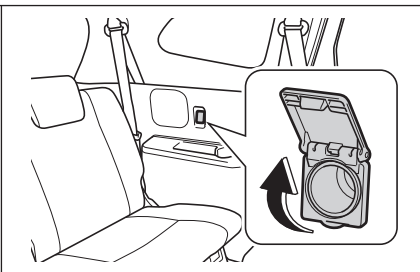
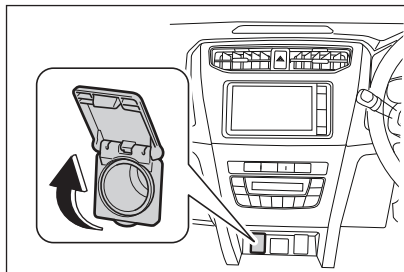

\*Ignition switch set to "ACC" or "ON" position for use.

## GLASSES CASE

## ROOF RAIL \*

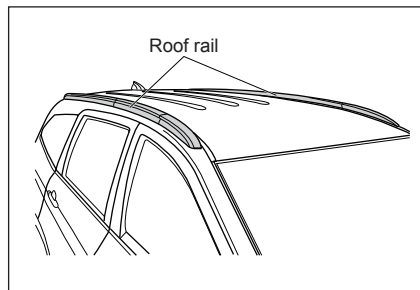
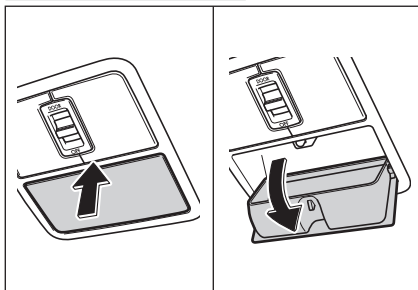

## BUILT-IN TOLL READER

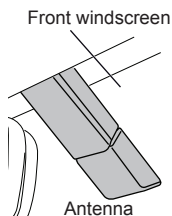
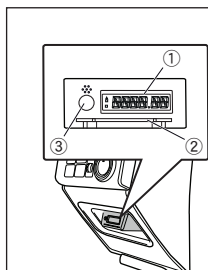

- ① LCD
- ② Card slot
- ③ Press button to check the prepaid card balance

\* Card not included

\* : The equipment may vary according to the vehicle grade and options.

## DVR\*

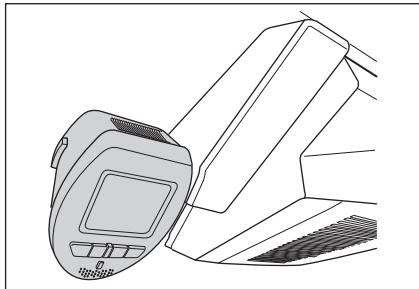

## SEAT POCKET

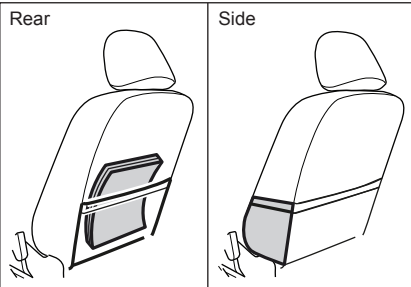

\* : The equipment may vary according to the vehicle grade and options.

# SAFETY & EMERGENCY

## FLOOR MAT INSTALLATION

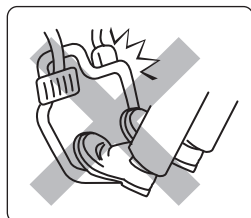
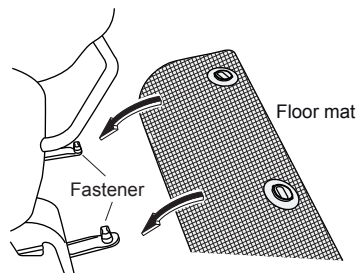

Before driving, ensure that the floor mat is installed securely in the correct position.

## SEAT BELTS

Front

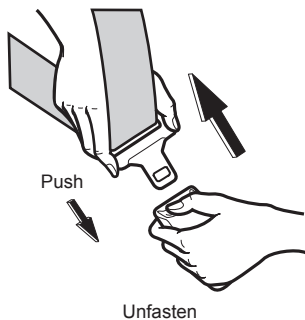
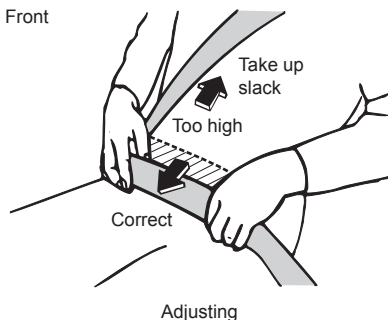

Rear

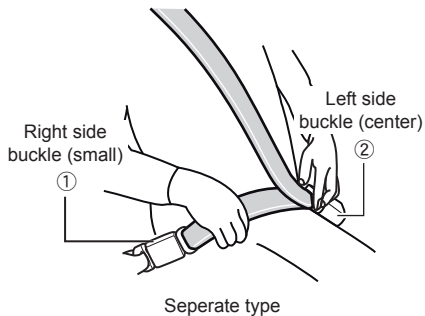

## FRONT SEAT BELT PRETENSIONER

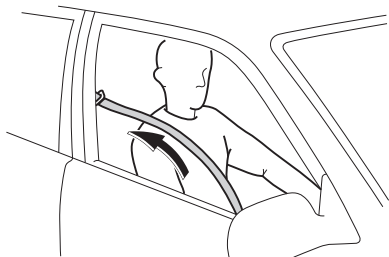

- Actuated when subjected to a strong impact from the front.
- Seat belt will instantly retract to secure the upper body of occupant.

## AIR BAGS

### SRS Front Air Bags

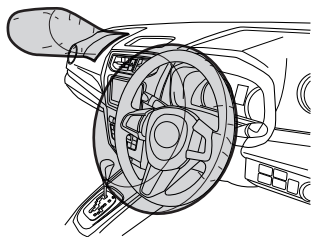

Severe impact from front of the vehicle

### SRS Side Air Bags

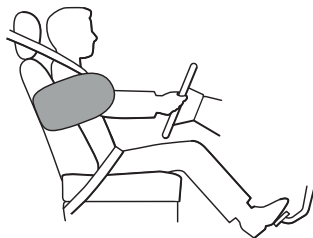

Severe impact from side of the vehicle

### SRS Curtain Air Bags

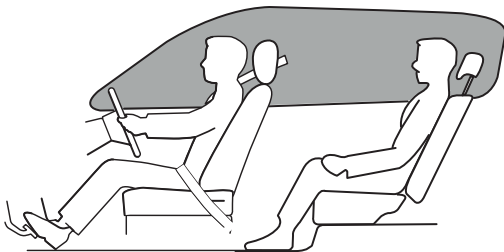

Severe impact from side & rear of the vehicle

## CHILD RESTRAINT SYSTEM

Baby seats



Child seats



Junior seats



- This vehicle is equipped with ISO FIX child restraint system seat.
- The child restraint seat should be properly installed on the rear seat.

## DOOR LOCK

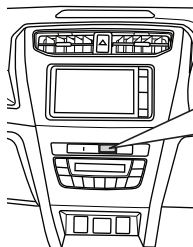

← Front of vehicle



Inside handle

← Front of vehicle

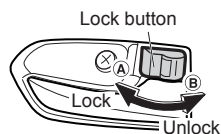

## DOOR CHILD SAFETY LOCK

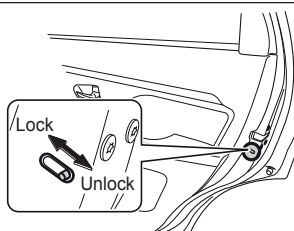

Moving the lever to "LOCK" will allow the door to be opened only from the outside.



## WINDOW JAM PROTECTION

The Window Jam Protection function is an auto-reverse safety feature. The window will stop rising when closing if the sensor detects an obstruction between the glass and window frame.

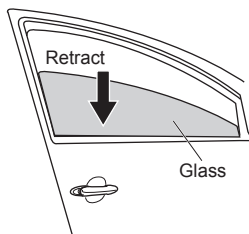
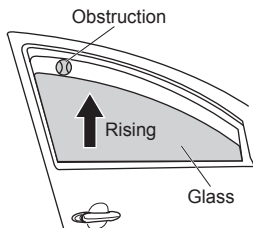

- Turn ignition switch "ON".
- Push and hold the power window switch down until window has opened completely.
- Hold the power window switch in the one - touch closing position.
- Continue holding the switch for a further 2 seconds after the window has closed completely.

Window jam Protection will not activate if obstruction is too small.

## TOOL BOX

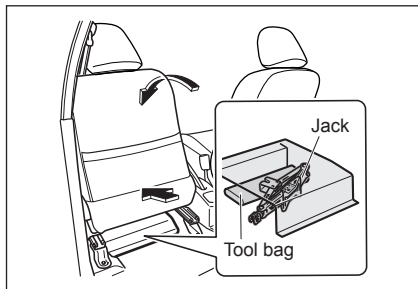

## SPARE TYRE LOCATION

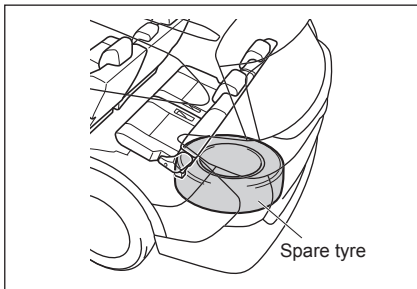

Refer to the Owner's Manual in section 11 for tyre changing and jack positioning procedure.

The following Wireless Communication products in this vehicle is certified (Type Approved) by SIRIM under Communication and Multimedia Act 1998



Keyless entry systems/immobilizer  
(smartkey transmitter),  
Immobilizer equipment (body ECU)



**PERODUA**

*Building Cars People First™*