

QUICK REFERENCE GUIDE

BEZEL
BEYOND COMPACT



Foreword

We are pleased to welcome you to the family of Perodua owners. As you know, the performance and durability of a vehicle depends, to a large extent, upon the way it is maintained and driven.

This Quick Reference Guide is a summary of basic vehicle operations. It contains brief description of fundamental operations so you can locate and use the vehicle's main equipment quickly and easily.

The Quick Reference Guide is not intended as a substitute for the vehicle Owner's Manual.

Full Owner's Manual can be downloaded from Perodua Official Website (www.perodua.com.my) or Perodua e-Owner's Manual page (<https://eownersmanual.perodua.com.my>).

For full awareness of your rights under the warranty granted and limitation set, please refer to the Warranty Booklet in Perodua e-Owners Manual page.

We strongly encourage you to review the Owner's Manual and any other supplementary manuals so you will have better understanding of your vehicle's capabilities and limitations.

If you have any questions, feel free to contact your authorised Perodua Service Centre. We are ready to provide qualified service and assistance

PERODUA SALES SDN. BHD.

©2021 PERODUA SALES SDN. BHD.

All rights reserved. This material may not be produced or copied, in whole or in part, without the written permission of Perodua Sales Sdn. Bhd.

Scan the QR code to visit the
e-Owner's Manual Website

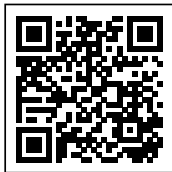

Owner's
Manual

DISCLAIMER

The information in this manual is subject to change without notice. No part of this manual may be reproduced or transmitted in any form or by any means electronic or mechanical including photocopying, recording or information storage and retrieval systems for any purpose other than personal use without our written permission.

While every effort has been made to ensure that the information and contents in the manual are complete, accurate, up-to-date, reliable and non-misleading, we cannot be held responsible for mistakes, inaccuracies, or errors found in the manual. Nor is any liability assumed for damages resulting from the reliance and use of information contained herein. This manual is provided without any representation or warranties, express or implied.

PERODUA SALES SDN. BHD.

INDEX

OVERVIEW

INSTRUMENT PANEL	1
INSTRUMENT CLUSTER	2
INDICATOR SYMBOL	2
SMART ENTRY*	4
PUSH START/STOP BUTTON*	6
FUEL TANK DOOR RELEASE AND CAP RELEASE	8
HOOD RELEASE	8

FEATURES & OPERATIONS

CLOCK	9
SEATS	10
SIDE MIRRORS	12
POWER WINDOWS	12
PARKING BRAKE	13
LIGHTS, TURN SIGNALS AND WIPERS	13
ASA (ADVANCED SAFETY ASSIST) 2.0*	15
PRE-COLLISION WARNING*	16
PRE-COLLISION BRAKING*	16
PEDAL MISOPERATION CONTROL *	17
FRONT DEPARTURE ALERT*	17
ECO IDLE SYSTEM*	18

FEATURES & OPERATIONS

(continued)

HILL - START ASSIST*	20
FRONT & REAR CORNER SENSOR*	21
VSC & TRC SYSTEMS*	22
ESS (EMERGENCY STOP SIGNAL)*	23
AIR CONDITIONER	24
AUDIO	25
BLUETOOTH OPERATION	26
USB SOCKET*	26
POWER SOCKET	26

SAFETY & EMERGENCY

FLOOR MAT INSTALLATION	27
SEAT BELTS	27
FRONT SEAT BELT PRETENSIONER	27
SRS AIRBAGS	28
TYPE OF CHILD RESTRAINT SYSTEM	28
DOOR LOCKS	29
CHILD SAFETY LOCK	29
WINDOW JAM PRO*	30
TOOL, JACK AND TYRE LOCATION	30

* : The equipment may vary according to the vehicle grade and options.

OVERVIEW

INSTRUMENT PANEL

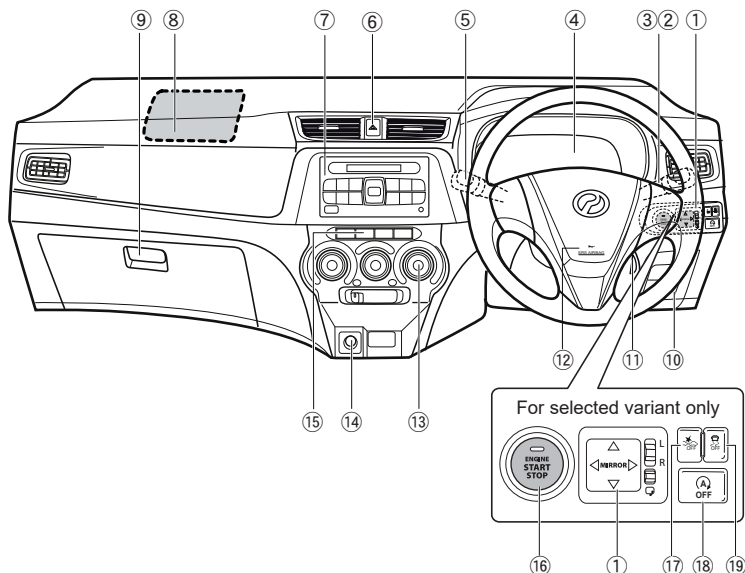

- ① Remote control outer mirror switch
- ② Turn signal control lever
- ③ Fog light switch*
- ④ Combination meter panel
- ⑤ Wiper and washer control lever
- ⑥ Hazard warning signal switch
- ⑦ Radio control panel
- ⑧ SRS air bags for front passenger
- ⑨ Glove box
- ⑩ Utility box

- ⑪ Ignition switch
- ⑫ SRS air bags for driver
- ⑬ Air conditioner control panel
- ⑭ Power socket
- ⑮ Rear window defogger switch
- ⑯ Engine start/stop button*
- ⑰ Advanced Safety Assist (ASA) OFF switch*
- ⑱ Eco Idle OFF switch*
- ⑲ VSC & TRC OFF switch*

* : The equipment may vary according to the vehicle grade and options.

INSTRUMENT CLUSTER

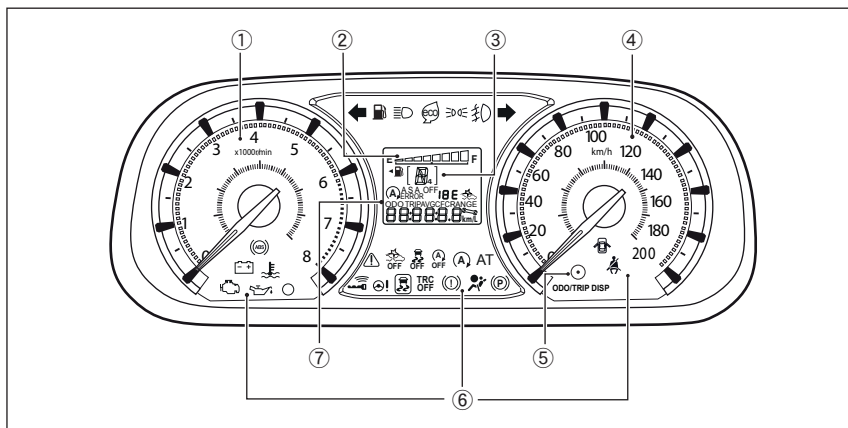

- | | |
|----------------------------|--------------------------------|
| ① Tachometer | ⑤ Reset button |
| ② Fuel gauge | ⑥ Warning and indicator lights |
| ③ AT shift indicator light | ⑦ Multi information display* |
| ④ Speedometer | |

INDICATOR SYMBOL

For details, refer to "Warning lights and Indicators" in Section 5 Owner's Manual.

	Brake warning light		Automatic transmission warning light
	Battery charge warning light		Airbag warning light
	Oil pressure warning light		ABS (Anti-lock Braking System) warning light
	Water temperature warning light		Power steering warning light
	Malfunction warning light (MIL)		Key-free warning light*

* : The equipment may vary according to the vehicle grade and options.



ASA OFF indicator light*



High beam indicator light

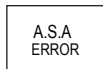

Advanced Safety Assist (ASA)
error warning light*



Front fog light-on indicator light*



Advanced Safety Assist (ASA)
OFF warning light*



VSC OFF indicator light*



Master warning light*



TRC OFF indicator light*



Slip indicator light*



Eco indicator light

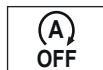

Eco Idle OFF indicator light*



ASA operation indicator light*

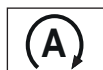

Eco Idle ready indicator light*



Door ajar warning light



Low fuel level warning light



Seat belt warning light



Parking brake warning light



Service information reminder
indicator

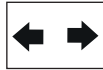

Turn signal indicator light/
Hazard warning signal indicator
light

If indicator does not turn off within a few seconds of starting engine, there may be a malfunction. Have the system checked by an authorised Perodua Service Centre.

* : The equipment may vary according to the vehicle grade and options.

SMART ENTRY*

LOCKING OPERATION

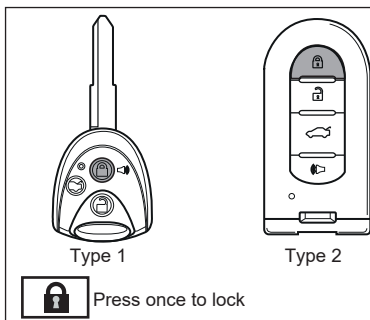

UNLOCKING OPERATION

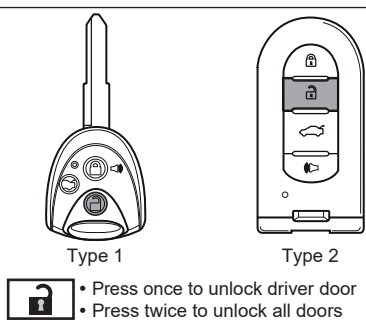

BACK DOOR UNLOCKING OPERATION

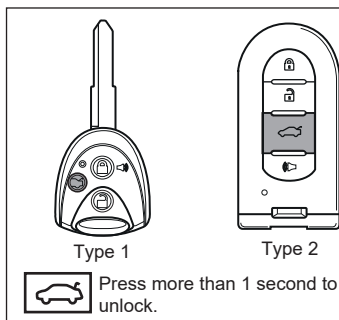

PANIC ALARM BUTTON*

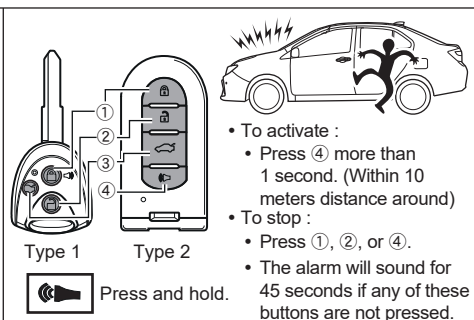

EMERGENCY KEY

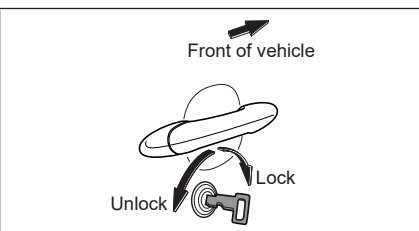
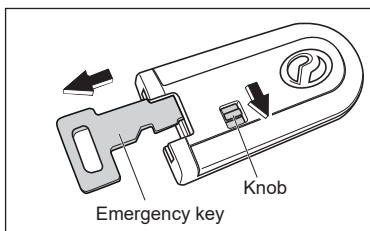

Push the knob downwards to release the emergency key.

Use the emergency key if the Smart Key battery is weak or if the keyless entry function does not operate properly.

* : The equipment may vary according to the vehicle grade and options.

LOCK / UNLOCK DOOR

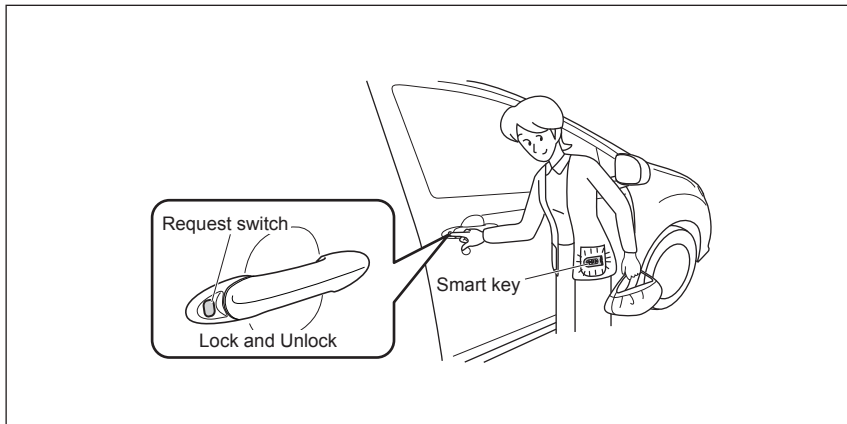

UNLOCK BACK DOOR

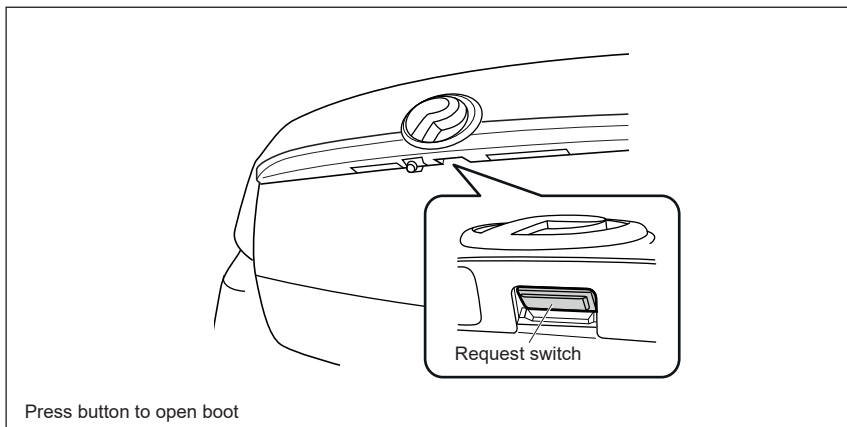

Operating range may vary by surrounding conditions.

- (i) Key-free: Within 3 meter from centre of vehicle.
- (ii) Request switch: When the smart key is within approximately 80 cm from outer door handle.

PUSH START/STOP BUTTON*

PUSH START SYSTEM*

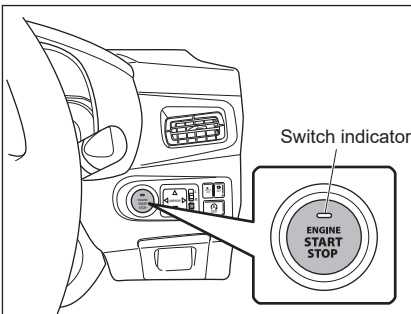

The Push Start/Stop Button allows you to start and stop the engine without inserting a key into ignition.

TO START ENGINE

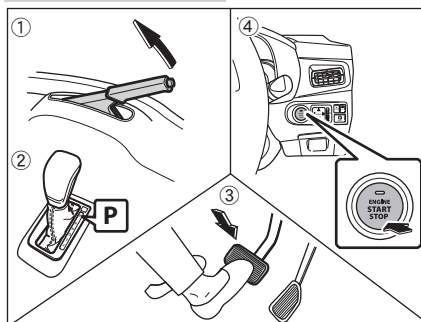

TO STOP ENGINE

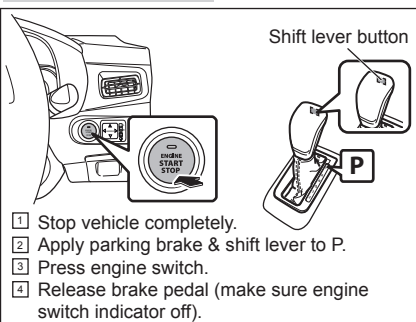

TO SWITCH ENGINE SWITCH MODE

Automatic Transmission

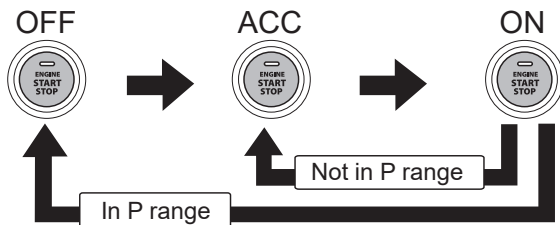

When brake pedal is not depressed, pressing the Push Start/Stop Button will change the engine mode.

* : The equipment may vary according to the vehicle grade and options.

SWITCHING ENGINE ON WHEN SMART KEY BATTERY IS WEAK

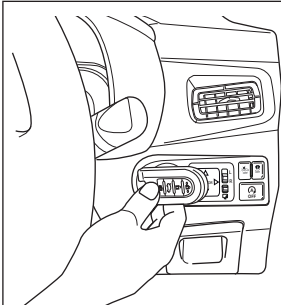

- 1 Move the shift lever to 'P' while depressing the brake pedal.
- 2 Touch the Smart Key with the engine switch until the buzzer sounds and the engine switch indicator turns green.
- 3 Press the engine switch within 4 seconds after step 2.

FUEL TANK DOOR RELEASE AND CAP RELEASE

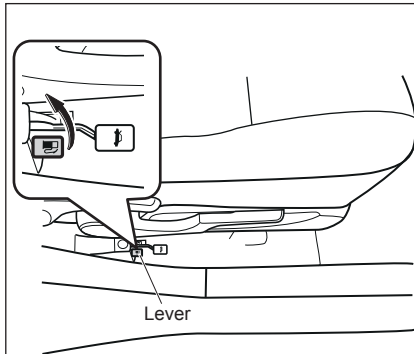

Pull up the remote fuel lid lever and open the fuel filler door.

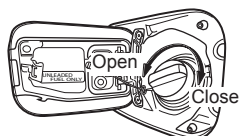

Turn and open the cap slowly. To close after refill, turn the cap opposite until clicking sound can be heard.

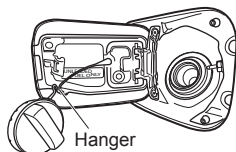

During filling, place the cap on the hanger.

HOOD RELEASE



Pull the hood release lever.

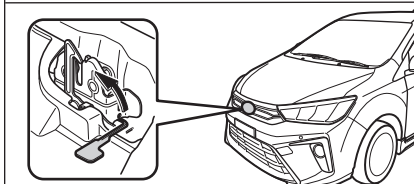

Lifting the lever and open the hood.

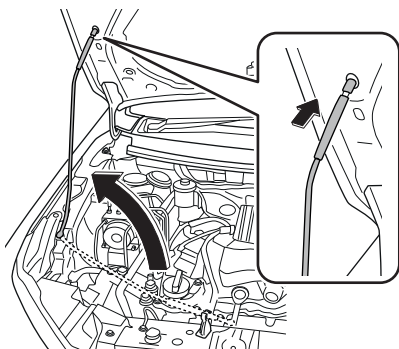

Unlatch and insert the supporting rod into the slot.

FEATURES & OPERATIONS

CLOCK

Hour

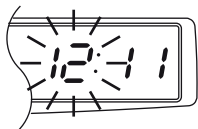

Minute

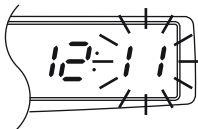

Selecting the time :

- 1 Press CLOCK button more than 2 seconds.
 - Press once to adjust hour.
 - Press again to adjust minute.
- 2 Use VOLUME button to increase/decrease the hour/minute.

SEATS

ADJUSTING THE SEATS

Front seats

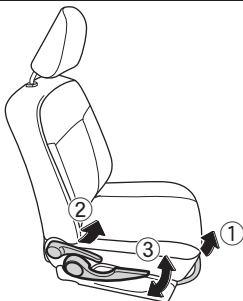

- ① Adjusts seat positions.
- ② Adjusts seatback reclining positions.
- ③ Adjusts seat height. (Driver's seat only)

FOLDING THE SEATBACK DOWN

Rear seats

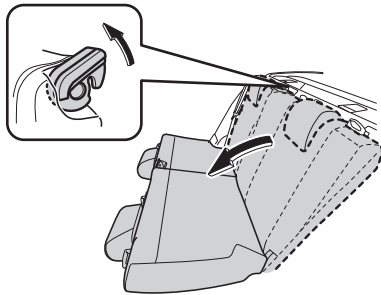
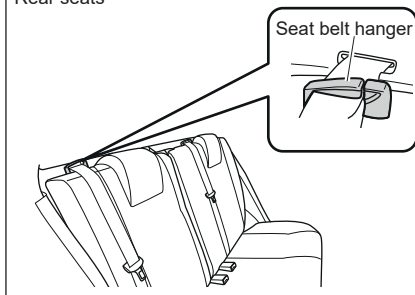

- ① Release the seat belt from the seat belt hanger and put it aside of the seat.
- ② Lower the headrest*.
- ③ Pull the seatback lock levers upward.
- ④ Slowly tilt the seatback and release the lever.

* : The equipment may vary according to the vehicle grade and options.

ADJUSTING THE HEAD RESTRAINTS

Front seats

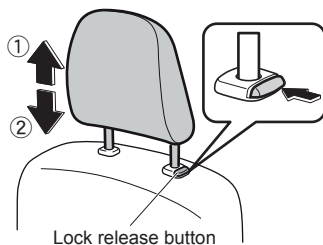

Installing

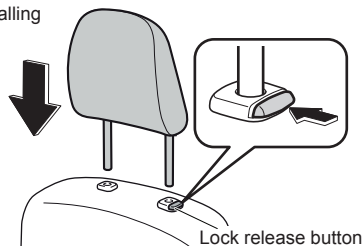

Align the head restraint and push release button while push the head restraint down.

Adjusting (front seats)

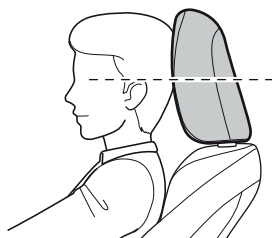

Adjusting its centre align with your ears.

SIDE MIRRORS

TO ADJUST

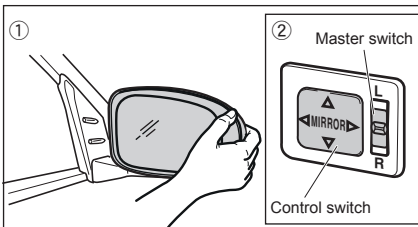

TO FOLD

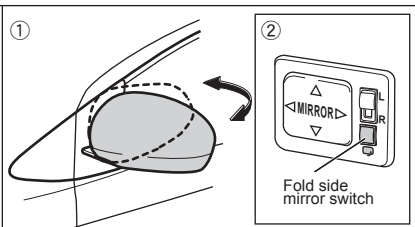

This component is enabled when the engine switch is in "ACC" or "ON" mode.

POWER WINDOWS

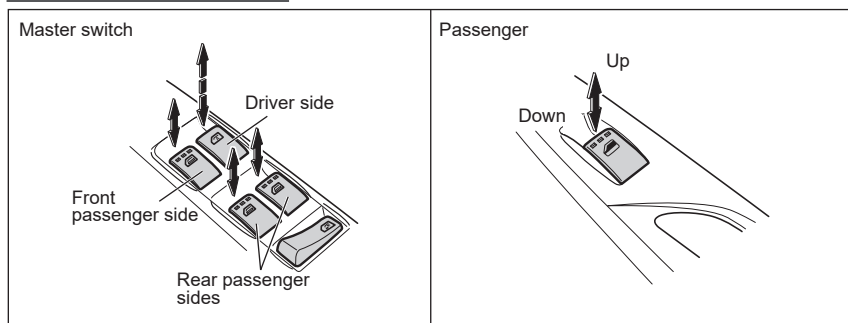

Automatic operation (Driver side only)

Push the switch down or pull it completely up and release to fully open or close. To stop window partially, push the switch lightly in the opposite direction during opening or closing.

* : The equipment may vary according to the vehicle grade and options.

PARKING BRAKE

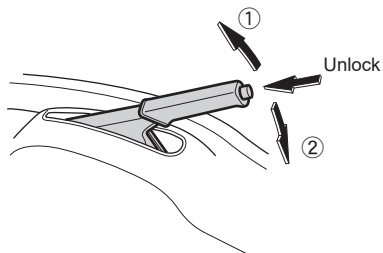

- ① To engage : Pull brake lever while pressing brake pedal.
- ② To release : Slightly pull brake lever up and all the way down while pressing the lever button.

LIGHTS, TURN SIGNALS AND WIPERS

TURN SIGNAL CONTROL LEVER

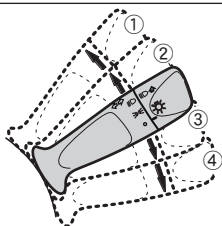

- ① Left turn.
- ② Lane change (left).
- ③ Lane change (right).
- ④ Right turn.

HEADLIGHT CONTROL

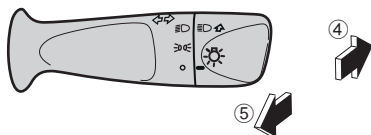
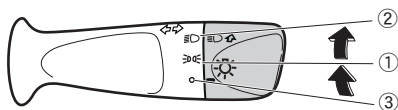

- ① Clearance lights, tail lights, licence plate lights, instrument panel lights.
- ② Lights on.
- ③ Lights off.
- ④ High beam.
- ⑤ Headlight flasher.

FOG LIGHT SWITCH*

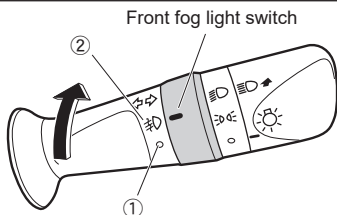

- ① Turn off the lights.
- ② Turn on the lights.

WINDSHIELD WIPER AND WASHER LEVER

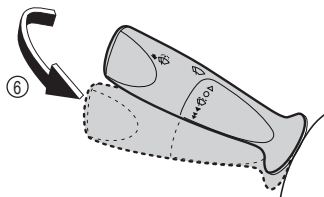
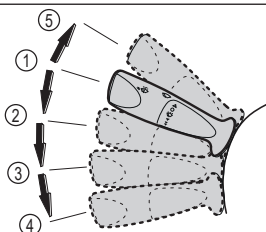

- ① ○ : OFF.
- ② ⏸ : Intermittent operation.
- ③ ▼ : Slow speed operation.

- ④ ⚡ : Fast speed operation.
- ⑤ △ : Temporary operation.
- ⑥ 🚿 : Washer.

During intermittent (INT) operation, the interval becomes shorter as the driving speed rises.

* : The equipment may vary according to the vehicle grade and options.

ASA (ADVANCED SAFETY ASSIST) 2.0*

ASA is a system designed to support the driver's awareness, decision making and vehicle operation contributing to a safe driving experience.

STEREO CAMERA

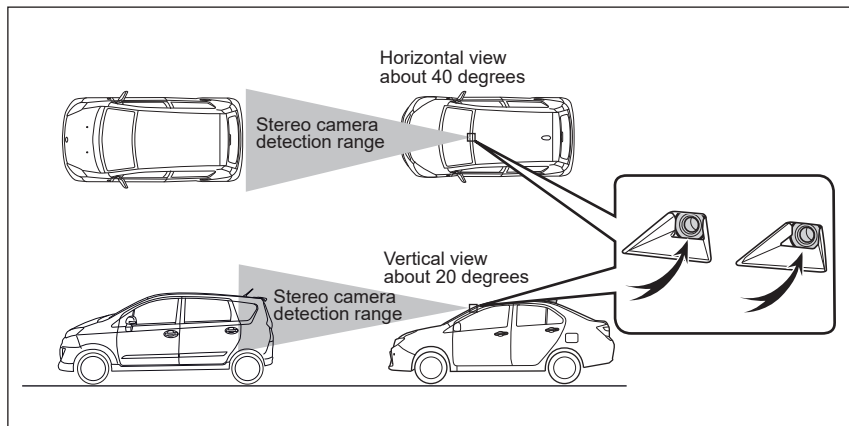

- A stereo camera mounted in front of the inside rear view mirror which detect vehicle up to about 60 m (pedestrian up to 30 m) in front.
- The stereo camera will not operate properly if the windshield view in front of the camera is obstructed by something, dirt, foggy, sticker etc.

ASA OFF SWITCH

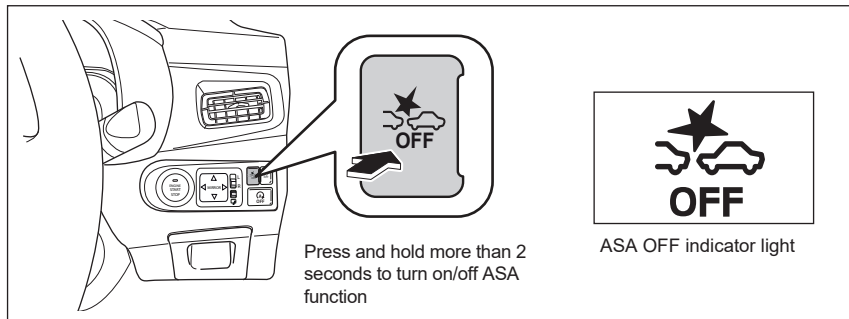

ASA OFF indicator light will illuminate at the meter panel. Every time you start the engine by the engine switch operation, ASA function will return to ready state.

Refer to the Owner's Manual (Section 10) for additional information on operation, settings adjustments, limitations and precautions before attempting to use it.

* : The equipment may vary according to the vehicle grade and options.

PRE-COLLISION WARNING*

Alert the driver when the stereo camera recognizes the high collision risk.

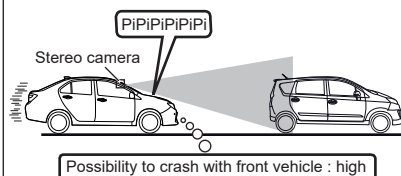

- When the system determines if there is a risk of collision, it will alerted and urged the driver to take evasive action by the buzzer and display.
- This function operates when the vehicle speed and speed difference between the front obstacles are :
4~100 km/h (vehicles).
4~50 km/h (pedestrian).

PRE-COLLISION BRAKING*

Control the brakes to assist in avoiding collision as well as contributing in mitigating collision damage.

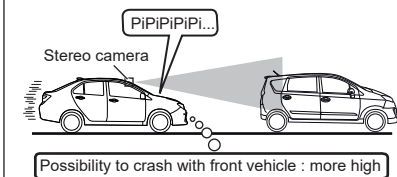

- If the system recognizes the front obstacles and determines that there is a high collision risk, it will change buzzer and control brakes.
- This function operates when the vehicle speed and speed difference between the front obstacles are :
4~80 km/h (vehicles).
4~50 km/h (pedestrian).
- If the brake pedal is depressed under following conditions, it helps to decelerate with more braking force than normal :
30~80 km/h (vehicles).
30~50 km/h (pedestrian).

- Continuously press the brake pedal to continue stop the vehicle because the vehicle will slowly start moving after 1.5 seconds.
- The operation cancelled if it determines low collision risk made by the driver such as pressing the brake pedal or operating the steering wheel.

Refer to the Owner's Manual (Section 10) for additional information on operation, settings adjustments, limitations and precautions before attempting to use it.

* : The equipment may vary according to the vehicle grade and options.

PEDAL MISOPERATION CONTROL*

This function assist driver in avoiding collision by controlling engine output when the driver accidentally press the accelerator pedal.

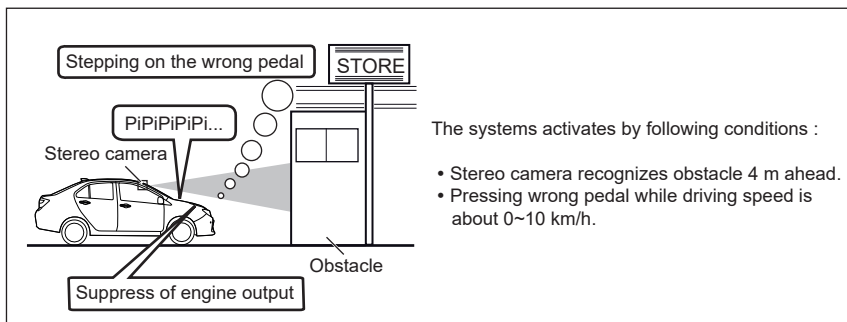

If the accelerator is pressed accidentally at approximately 4 km/h or less, the driver will be alerted by the buzzer and display.

FRONT DEPARTURE ALERT*

Alerts the driver when the vehicle in front has moved.

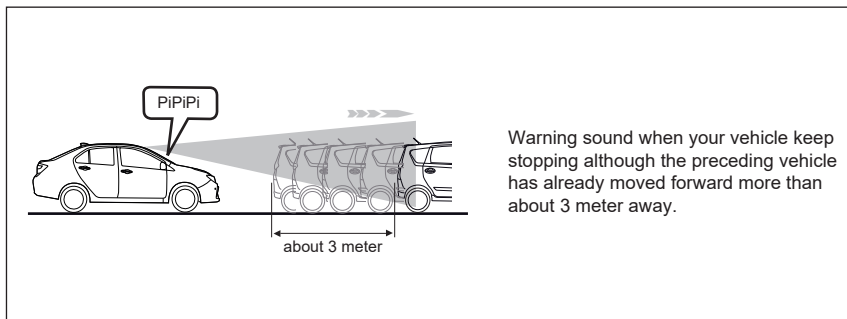

Shift position is other than **P** & **R** and distance between the stopped preceding vehicle and own vehicles is within about 10 meter.

Refer to the Owner's Manual (Section 10) for additional information on operation, settings adjustments, limitations and precautions before attempting to use it.

* : The equipment may vary according to the vehicle grade and options.

ECO IDLE SYSTEM*



The 'eco IDLE' is a system that stop and restart the engine with the brake pedal without using the engine switch while the vehicle stops at a red traffic light or an intersection.

Eco Idle ready indicator light*

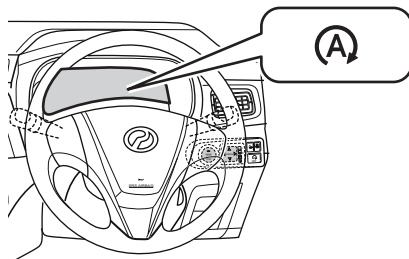

Eco Idle OFF switch*

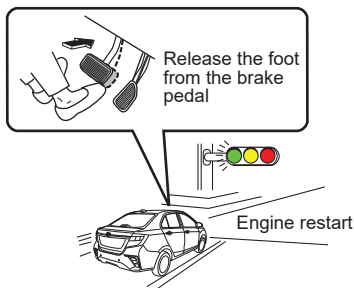
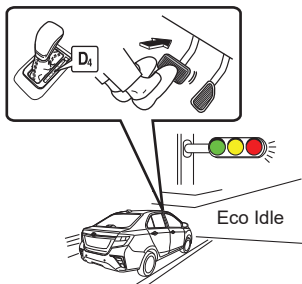
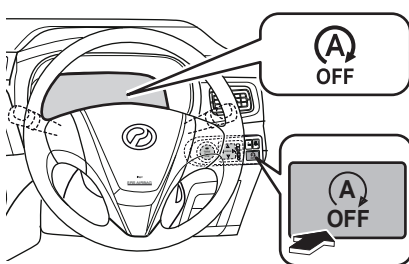

- ① When conditions for 'Eco Idle' mode are fulfilled during driving, the 'Eco Idle' ready indicator turns on in green colour (standby state).
- ② While the shift lever is in D_4 , depress the brake pedal and stop your vehicle for 'Eco Idle' mode. The indicator will remain on in green during 'Eco Idle' mode.
- ③ The engine restarts when foot is released from the brake pedal. The 'Eco Idle' ready indicator will turn off.
- ④ The 'Eco Idle' ready indicator turn on in green again after conditions for 'Eco Idle' mode are fulfilled.

Refer to the Owner's Manual (Section 10) for additional information on operation, settings adjustments, limitations and precautions before attempting to use it.

* : The equipment may vary according to the vehicle grade and options.

Eco Idle' may not operate normally under the following conditions. Have the vehicle checked by an authorized Perodua Service Centre.

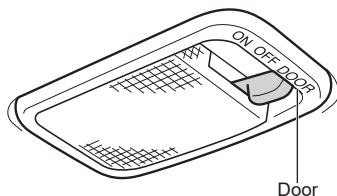

The interior light turns on when the driver's door is closed and does not turn on when the driver's door is opened.



Door ajar warning light turns on when the driver's door is closed and does not turn on when the driver's door is opened.



Seat belt reminder light flashes when driver's seatbelt is fastened, and/or does not flash when driver's seat belt is not fastened.

Refer to the Owner's Manual (Section 10) for additional information on operation, settings adjustments, limitations and precautions before attempting to use it.

HILL - START ASSIST*

Hill-Start Assist System helps to prevent the vehicle from rolling back when starting up again from a stopped position on an incline.

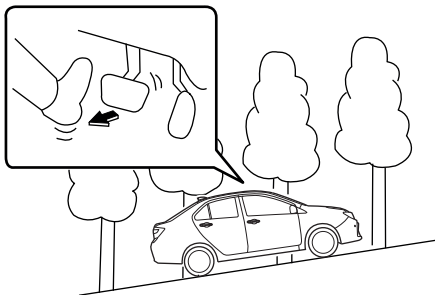

① Release the brake pedal slowly.

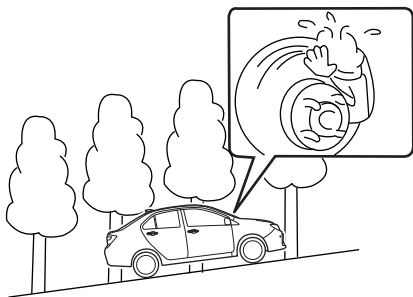

② Vehicle retains brake force for 2 seconds.

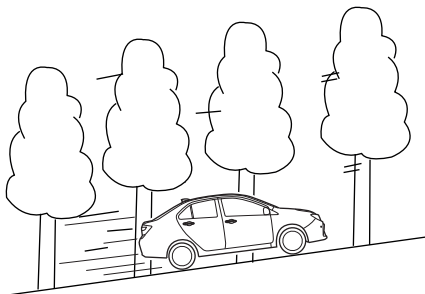

③ Accelerate to continue driving.

* : The equipment may vary according to the vehicle grade and options.

FRONT & REAR CORNER SENSOR*

SONAR LOCATIONS AND TYPES

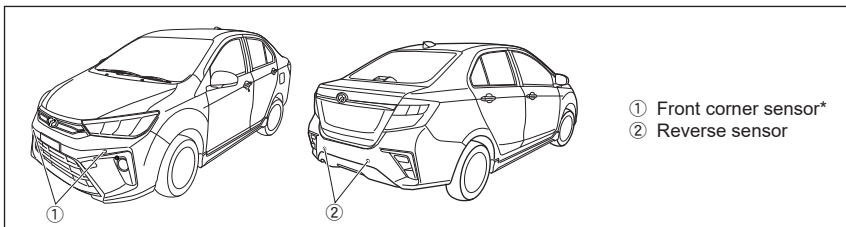

FRONT CORNER SENSOR SWITCH*

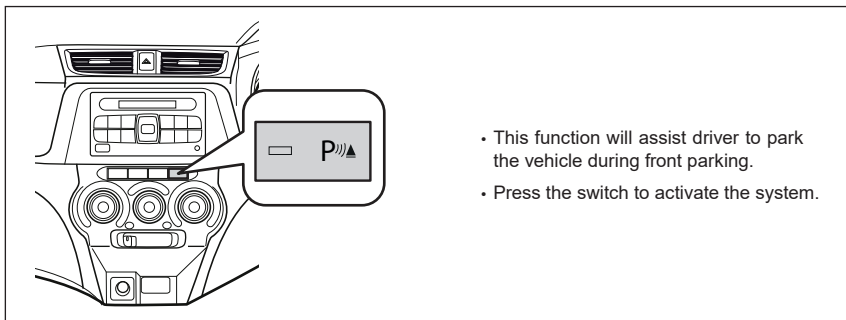

* : The equipment may vary according to the vehicle grade and options.

VSC & TRC SYSTEMS*

Vehicle Stability Control (VSC)

Keeps the vehicle stable during sudden turns or on slippery roads.

Traction Control (TRC)

Assists with keeping the stability of the vehicle when accelerating on slippery roads.

VSC & TRC OPERATION

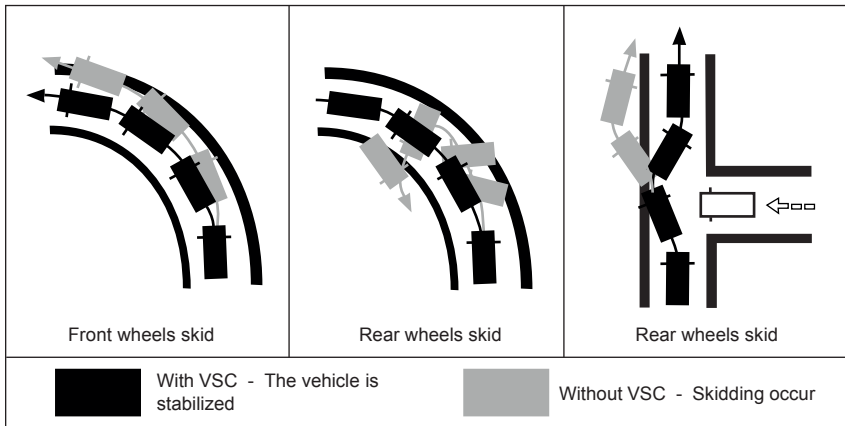

- These situations may arise depending on road, tyre and weather conditions.
- The vehicle is more secure if it is equipped with ABS (Anti-lock Braking System) & EBD (Electronic Brake force Distribution.)

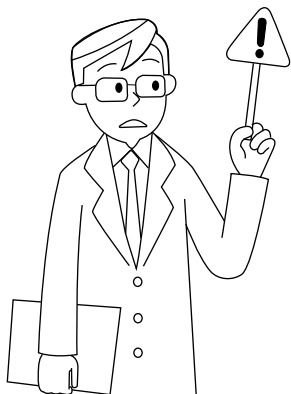

IMPORTANT:

Even when VSC & TRC are operation, there are limits to the systems' traction and stability control. Dangerous driving may still cause accidents.

* : The equipment may vary according to the vehicle grade and options.

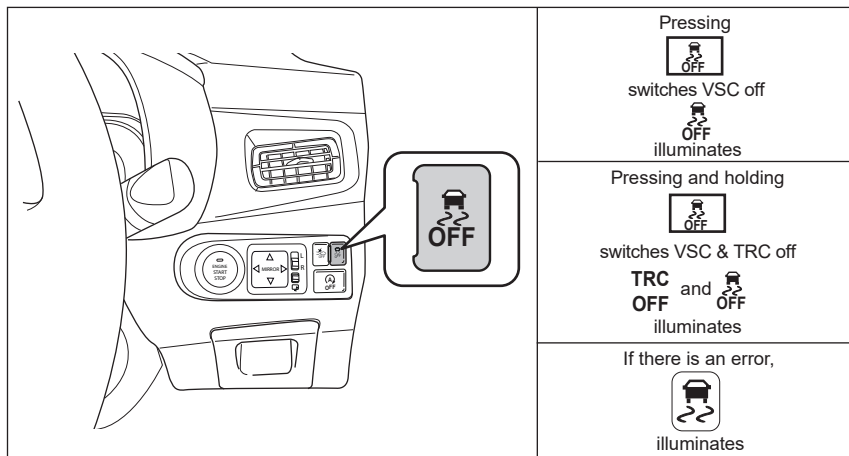

ESS (EMERGENCY STOP SIGNAL)*

Emergency stop signal system reduces the risk of collision by automatically flashing the hazard lights when the brakes applied suddenly to alert the vehicle behind.

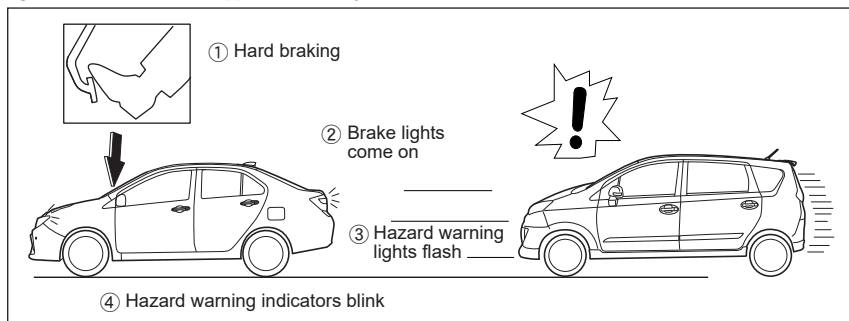

Emergency stop signal operating conditions :

- Hazard warning signal light is OFF.
- Vehicle speed is about more than 60 km/h.
- The system detect any “hard” or “sudden braking” or ABS is activated.

Driver is obliged for a safe driving and avoid unnecessary sudden braking.

* : The equipment may vary according to the vehicle grade and options.

AIR CONDITIONER

Make sure the ignition switch is ON to operate the air conditioner blower.

AIR CONDITIONER ON

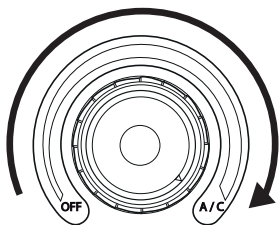

Turn the temperature control dial to "ON" the air conditioner.

TEMPERATURE CONTROL DIAL

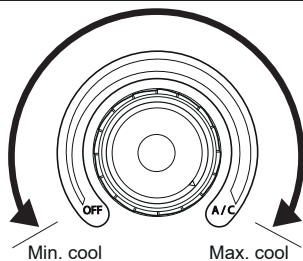

Adjust the temperature by adjusting this dial.

BLOWER FAN SWITCH

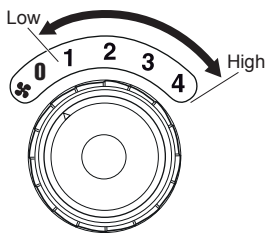

Air flow speed is change with this switch.

AUDIO

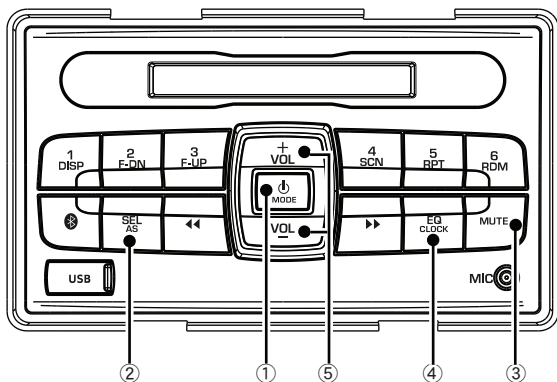

Refer to "Owner's Manual" (Section 7) for more details.

- | | |
|---------------------|--------------------------|
| ① Power/mode button | ④ Equalizer/clock button |
| ② Select button | ⑤ Volume button |
| ③ Mute button | |

BLUETOOTH OPERATION

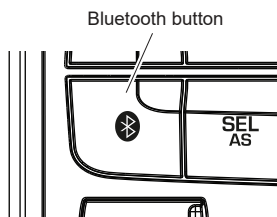

- ① Press and hold Bluetooth button for 2 seconds to enter pairing mode.
- ② LCD will display "PAIRING" and "⌘" will flashing.
- ③ Confirm default passkey "0000" in both device and unit.
- ④ The Audio system will connected automatically and "⌘" will stop flashing.

Refer to "Owner's Manual" (Section 7) for more details.

USB SOCKET*

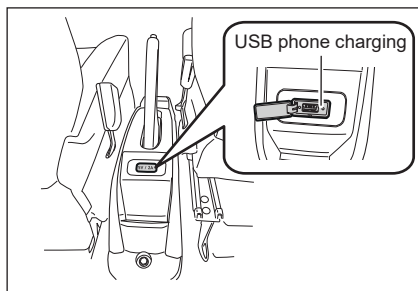

POWER SOCKET

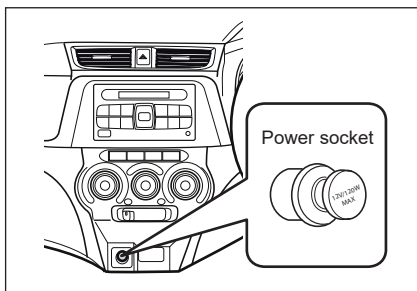

* : The equipment may vary according to the vehicle grade and options.

SAFETY & EMERGENCY

FLOOR MAT INSTALLATION

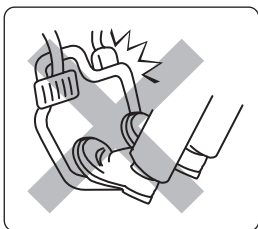
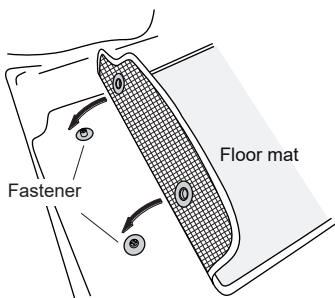

Before driving, ensure that the floor mat is installed securely in the correct position.

SEAT BELTS

Fasten

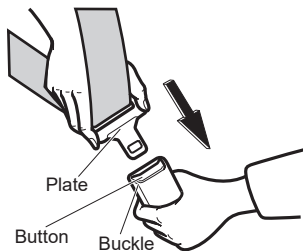

Unfasten

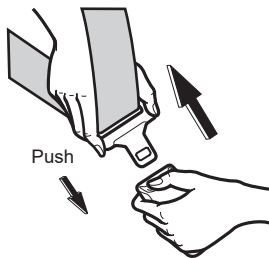

Push the buckle release button.

FRONT SEAT BELT PRETENSIONER



- Actuated when subjected to a strong impact from the front.
- Seat belt will instantly retract to secure the upper body of occupant.

SRS AIRBAGS

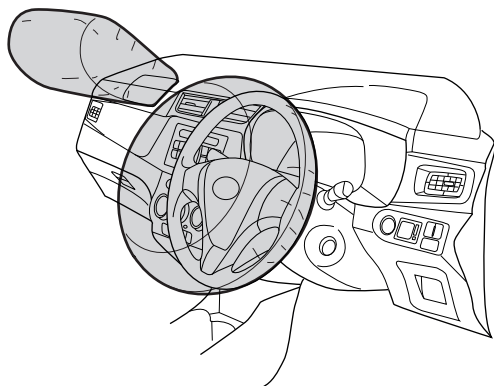

The SRS airbags help to reduce impacts to the driver's and passenger's faces, heads, chests and so forth.

TYPE OF CHILD RESTRAINT SYSTEM

Baby seat

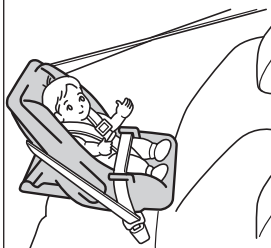

Child seat



Junior seat



- This vehicle is equipped with ISOFIX child restraint system seat.
- The child restraint system should be properly installed on the rear seat.

DOOR LOCKS

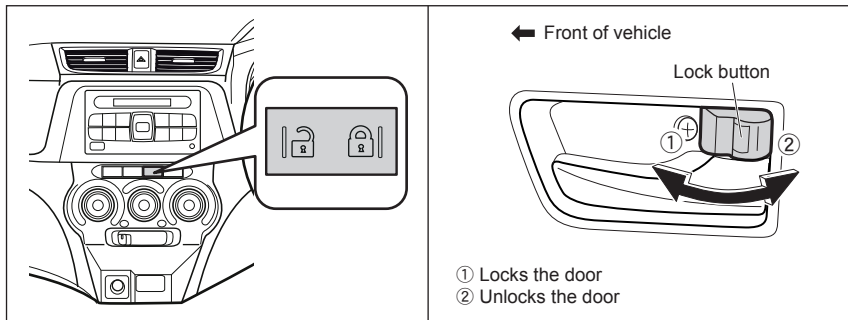

CHILD SAFETY LOCK

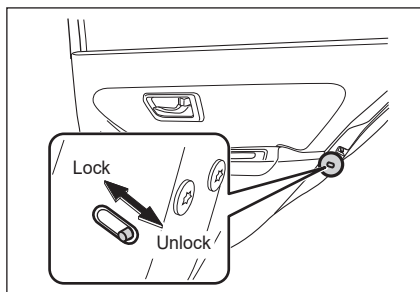

WINDOW JAM PRO*

Jam Protection Function is only available for driver's window only. If an object caught between the window and window frame still closing, the window will open slightly and stop moving.

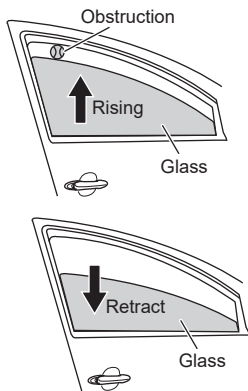

- Turn ignition switch "ON".
- Push and hold the power window switch down until window has opened completely.
- Hold the power window switch in the one - touch closing position.
- Continue holding the switch for a further 2 seconds after the window has closed completely.

Window Jam Protection will not activate if obstruction is too small.

TOOL, JACK AND TYRE LOCATION

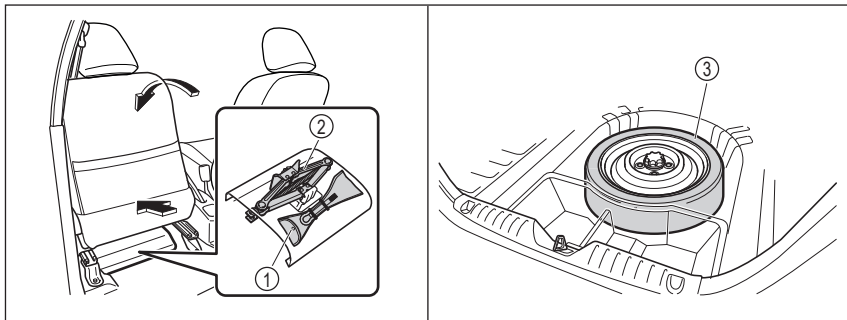

- ① Tool bag (Jack handle, hub nut wrench, towing hook & band)
- ② Jack
- ③ Spare tyre

Refer to the Owner's Manual (Section 11) for tyre changing and jack positioning procedure.

* : The equipment may vary according to the vehicle grade and options.

The following Wireless Communication products in this vehicle is certified (Type Approved) by SIRIM under Communication and Multimedia Act 1998



Keyless entry systems (keyless transmitter),
Keyless entry systems/immobilizer
(smartkey transmitter),
Immobilizer equipment (body ECU)



Immobilizer systems



PERODUA

Building Cars People First™